

BIDDING REQUIREMENTS for PURCHASING

NOTICE AND INFORMATION FOR BIDDERS

**Attachment A: Bid Breakdown & Schedule**

Bidder: \_\_\_\_\_

DASNY Contact: Susan Valente, Purchasing Coordinator - [svalente@dasny.org](mailto:svalente@dasny.org)

Services/Product Required By: July 15, 2022

Description: Furnish and deliver light fixtures – Bid No. 729

Bid Open Location: DASNY, Corporate Headquarters, 515 Broadway, Albany, NY 12207

Bid Open Date and Time:

Item No.	Manufacturer	Make/Model	Description	QTY	UOM	Unit Price	Extended Price
1	CGF Design, Inc., or equal*	LDG-DF-PGC-48-LED40-CT4-80CRI-UNV-WHT-0-10D1, or equal*	LEDGE High Abuse Linear Collection – LED Luminaire	124	EA	\$	\$
2							
3						\$	\$
4						\$	\$
5						\$	\$
6						\$	\$
7						\$	\$
8						\$	\$
9						\$	\$
10						\$	\$
11						\$	\$
12						\$	\$

*\*If bidding or proposing commodities other than those specified, the bidder must in every instance give all information required in Section 2.0 (B) of the Notice and Information for Bidders. Products will only be considered if proof of comparability is provided to DASNY in writing. A determination that a commodity or product is an “or equal” will be determined by DASNY in its sole and absolute discretion and any such determination will be final.*

**INSTALLATION LABOR (if required)  
LABOR TO INSTALL: Not Applicable**

**Estimated No. of Hours: Not Applicable**

**Hourly Rate (Prevailing Wage rates are required for this work): Not Applicable**

Total Materials/Equipment/Commodities: \_\_\_\_\_

Total Installation: Not Applicable

**TOTAL BID** \_\_\_\_\_

BIDDING REQUIREMENTS for PURCHASING

NOTICE AND INFORMATION FOR BIDDERS

(The below questions 1) and 2) need only be answered if the above total bid is for one million dollars or more)

- 1. Does your firm anticipate the use of subcontractors and outside suppliers specific to this procurement  
Yes  No
- 2. Does your firm anticipate the creation of employment opportunities arising from this procurement?  
Yes  No

(The below information must be completed for all bids.)

Identify all subcontractors, if any: \_\_\_\_\_

STATE, PROVINCE FOR FOREIGN COUNTRY  
THAT YOUR FIRM'S PRINCIPAL PLACE OF  
BUSINESS IS LOCATED:

\_\_\_\_\_

ADDRESS OF FACTORY OR PLANT WHERE  
ITEMS ARE MANUFACTURED AND/OR  
ASSEMBLED. (Attach additional sheet(s) if more  
than one manufacturer)

\_\_\_\_\_

\_\_\_\_\_

\_\_\_\_\_

\_\_\_\_\_

\_\_\_\_\_  
BIDDER (FIRM NAME)

\_\_\_\_\_  
SIGNATURE

\_\_\_\_\_  
NAME (TYPE/PRINTED)

\_\_\_\_\_  
TITLE

\_\_\_\_\_  
Date

BIDDING REQUIREMENTS for PURCHASING

NOTICE AND INFORMATION FOR BIDDERS

**Attachment B: Detailed Specifications**

See attached Product Specification Sheet and Product Cut-Sheet

# PRODUCT SPECIFICATION SHEET

Project: DASNY UB Clement Hall Renovations  
DASNY Project No.: 3664109999  
Location: Various Toilet Rooms



Description: LEDGE High Abuse Linear Collection – LED Luminaire

Quantity: 64 fixtures delivered by 7/15/22, plus an additional 60 fixtures delivered by 12/31/22 for a total of 124 fixtures  
Model Number: LDG-DF-PGC-48-LED40-CT4-80CRI-UNV-WHT-0-10D1  
Manufacturer: CGF Design Inc.  
Color: White  
Lens: PGC  
Light Position: Down Forward (DF)  
Power: LED40

\*\*Product Cut-Sheet and installation instructions attached

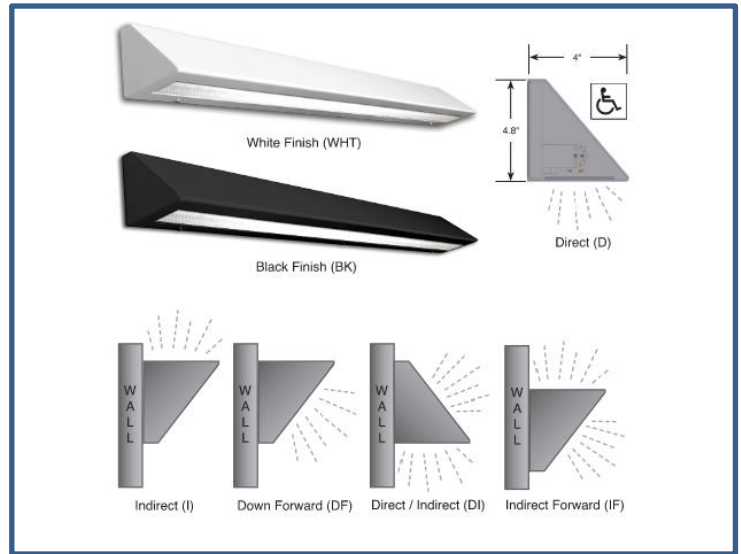

## Detailed Product Specifications:

Product is 48" long x 4.8" high with a 4" projection.

Delivery Method: Delivery provided by vendor, installation by the College.

### INSTALLATIONS

- HOSPITALS
- ASSISTED LIVING
- HOSPITALITY
- RETAIL
- NATATORIUMS / PUBLIC POOLS
- SCHOOLS
- STRIP CENTERS

### APPLICATIONS

- EGRESS
- BEDLIGHT
- CORRIDORS
- STAIRWELLS
- VANITY
- EAVES
- CONFERENCE ROOMS



White Finish (WHT)



Black Finish (BK)

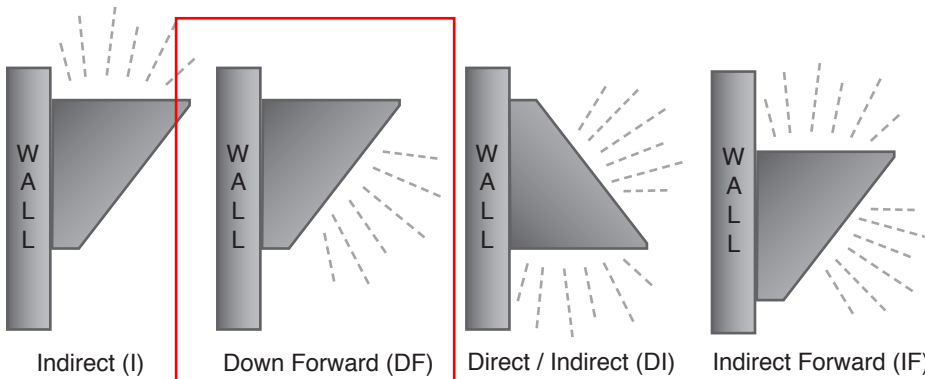
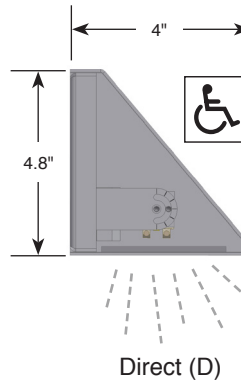

Catalog Number

Project Name & Location

Type

### order example:

**LDG-D-48-LED40-CT4-80CRI-UNV-SU-BK**

#### SERIES

LDG Ledge Series

#### STYLE

- D Direct (Downlight)
- DF Down / Forward Throw Light (Downlight)
- DI Direct (Downlight) / Indirect (Uplight)
- IF Indirect (Uplight) / Forward Throw Light
- I Indirect (Uplight)

#### LENS

- PGC Clear Prismatic Polycarbonate - STANDARD  
– Includes Glare Control
- OP Opal Lens

**SIZE/LED WATTAGE (See 2nd Page for Lumen Info)**  
Choose: LED or LEDH (High Output)

14"	LED20 <sup>1</sup> / LEDH21 <sup>2</sup>
24"	LED20 <sup>1</sup> / LED30 <sup>2</sup> / LEDH35 <sup>2</sup>
36"	LED30 <sup>1</sup> / LED40 <sup>2</sup> / LEDH45 <sup>2</sup>
48"	LED40 <sup>1</sup> / LED50 <sup>2</sup> / LEDH60 <sup>2</sup>

- <sup>1</sup> = Fixture Does Not Require Backbox (CA) - ADA
- <sup>2</sup> = Fixture Requires Backbox (CA) - Non-ADA

#### LED COLOR TEMPERATURE

- CT27 ±2700K LED Color Temp
- CT3 ±3000K LED Color Temp
- CT35 ±3500K LED Color Temp
- CT4 ±4000K LED Color Temp
- CT5 ±5000K LED Color Temp

#### COLOR RENDERING INDEX OPTIONS

- 80CRI 80 Color Rendering Index - STANDARD
- 90CRI 90 Color Rendering Index
- 96CRI 96 Color Rendering Index

#### VOLTAGE

- 347 347 Volt
- UNV 120~277 Universal Volt Electronic Driver
- 2UNV Two 120~277 Universal Volt Electronic Drivers  
– Requires Conduit Adapter Back Box (CA)

#### FINISH

- AM Anti-Microbial Finish
- BK Black
- BZ Bronze
- NAT Epoxy Coating for Natatorium Finish  
– Includes Conformal Coating for LEDs
- PA Painted Aluminum
- SS Stainless Steel
- WHT Textured White - STANDARD
- CC Custom Color (Visit [www.ralcolor.com](http://www.ralcolor.com))

**ADDITIONAL OPTIONS on Page 2**



### Product Specifications

**DRIVER:** Universal Volt 120/277v electronic driver with 0-10V dimming is standard.

**HOUSING:** Heavy gauge aluminum houses all wiring and components.

**LENS:** Prismatic Lens Standard. Optional Opal Polycarbonate.

**FINISH:** White standard finish. Optional Black, Bronze, OR Painted Aluminum.

**LIGHT ENGINE:** Energy efficient LED.

**COMPLIANCE:** Built according to US & Canadian Standards. Suitable for Wet Locations. **Made in USA / Buy America Compliant / Buy American Act.**

### LEDGE DIRECT / INDIRECT MODELS



Ledge 48" Direct / Indirect Style (DI)  
Downlight and Uplight



Ledge 48" Downward / Forward Style (DF)  
Angled Downward Throw Light

### LED WATTAGE / LUMEN DATA CHARTS

LED / MAX WATTAGE PER SIZE					
Fixture		SIZE 14	SIZE 24	SIZE 36	SIZE 48
Dimensions L x H x D		14" x 4.5" x 4"	24" x 4.8" x 4"	36" x 4.8" x 4"	48" x 4.8" x 4"
Light Emitting Diode	LED	20W <sup>1</sup>	20W <sup>1</sup> / 30W <sup>2</sup>	30W <sup>1</sup> / 40W <sup>2</sup>	40W <sup>1</sup> / 50W <sup>2</sup>
Light Emitting Diode High Output	LEDH	21W <sup>2</sup>	35W <sup>2</sup>	45W <sup>2</sup>	60W <sup>2</sup>

<sup>1</sup> = Fixture Does Not Require Backbox (CA) - ADA

<sup>2</sup> = Fixture Requires Backbox (CA) - Non-ADA

LED Watts vs. LED Color Temp — Lumen Output				
Color Temperature	3000K (3K)	3500K (35K)	4000K (4K)	5000K (5K)
15 Watt	2298 Lumens	2333 Lumens	2381 Lumens	2452 Lumens
20 Watt	3461 Lumens	3503 Lumens	3578 Lumens	3685 Lumens
21 Watt (High Output)	N/A	N/A	3732 Lumens	N/A
30 Watt	4607 Lumens	4677 Lumens	4776 Lumens	4919 Lumens
35 Watt (High Output)	N/A	N/A	6440 Lumens	N/A
40 Watt	5722 Lumens	5793 Lumens	5917 Lumens	6099 Lumens
45 Watt (High Output)	N/A	N/A	8394 Lumens	N/A
60 Watt (High Output)	N/A	N/A	11,102 Lumens	N/A

NOTE: Lumen Output listed is estimated based upon delivered lumens at 25°C. See Lumen Ambient Temperature Multipliers Table to determine lumen output for other ambient temps.

Projected LED Lumen Maintenance	
Operating Hours	Lumen Maintenance Factor
0 Hrs	1.0
25,000 Hrs	0.97
50,000 Hrs	0.95
100,000 Hrs	0.90

Lumen Ambient Temperature (LAT) Multipliers	
Ambient Temperature	Lumen Multiplier
0°C / 32°F	1.05
10°C / 50°F	1.03
20°C / 68°F	1.01
25°C / 77°F	1.00
30°C / 86°F	0.99
40°C / 104°F	0.96

NOTE: Use these multipliers to determine relative lumen output for average ambient temps for 0-40°C (32-104°F).

### DIMMING OPTIONS

- 0-10D1 0-10VDC LED Dimming Driver (100-10%)
- 0-10D2 0-10VDC LED Dimming Driver (100-1%)
- 12DIM Lutron Dimming

### CONTROL OPTIONS

Note1: Motion Sensor Max Mounting Height 18-Feet  
Note2: See Accessory Options for Required Remote Controller

- OCC Occupancy Sensing | Motion Sensor Integral  
– Microwave / Single Feed / 120/277 Only  
– Stand-by Dim Level Presets: On/Off (0%/100%)
- BLD Bi-Level Dimming | Motion Sensor Integral  
– Microwave / Single Feed / 120/277 Only  
– Stand-by DimLevel Presets:  
10% / 20% / 30% (Standard) / 50%
- BLD/AMB Bi-Level Dimming | Motion Sensor Integral  
– Ambient Light Sensing Feature (AMB)  
– Microwave / Single Feed / 120/277 Only  
– Stand-by Dim Level Presets:  
10% / 20% / 30% (Standard) / 50%  
– Bi-Level Control Initiated at AMB Light Level Preset
- BLS Bi-Level Switching - Uses 2 Drivers (2UNV)

PHTD Photocell Button (120/277V)

### CONDUIT ADAPTER BACKBOX OPTIONS For Surface Conduit or Emergency Battery

- CA1 14" X 1.75" Back Box
- CA2 24" X 1.75" Back Box
- CA3 36" X 1.75" Back Box
- CA4 48" X 1.75" Back Box
- CA4D 48" X 2" Back Box

### MISC OPTIONS

- FUS Single Fusing
- FUS2 Double Fusing
- TP Tamperproof Screws
- SU 10KV Surge Protection (ANSI: C62.41.2)

### ACCESSORY OPTIONS

Order As A Separate Line

- TPD Tamperproof Screwdriver
- REMT Remote Controller for Sensor Options

### EMERGENCY / BATTERY OPTIONS

- No Onsite Emergency (AC / DC) is Provided
- Emergency Battery Options Meet California Energy Commission Title 20 [CEC-400-2014-009-CMF] Efficiency Standards  
– Cold Weather Batteries DO NOT meet CEC Standards
- Cold Weather Emergency Batteries Temp Range: -20°C thru 50°C
- Integral Emergency Battery Options  
Requires Conduit Adapter (CA Option)  
Ledgge Size 14 with CA Option compatible with EM4W Only

- GN1 Generator Transfer Device (Signify)
- GN2 Generator Transfer Device (LGTD)  
– Shunt Relay with Fire Alarm Override Input
- EM4W Integral 4 Watt LED
- EM8W Integral 8 Watt LED
- EM16W Integral 16 Watt LED
- REM4W Remote 4 Watt LED
- REM8W Remote 8 Watt LED
- REM16W Remote 16 Watt LED
- REM20W Remote 20 Watt LED
- REM10W-CW Remote 10 Watt LED - Cold Weather
- REM7W-CP Remote 7 Watt LED - Constant Power
- REM10W-CP Remote 10 Watt LED - Constant Power
- REM12W-CP Remote 12 Watt LED - Constant Power

## SAFETY INSTRUCTIONS

1. Disconnect main power before servicing luminaires.
2. Proper grounding is required to insure personal safety.
3. All work should be done by a qualified electrician.

## WARNING: RISK OF ELECTRIC SHOCK

Disconnect Power before starting installation or servicing luminaire.

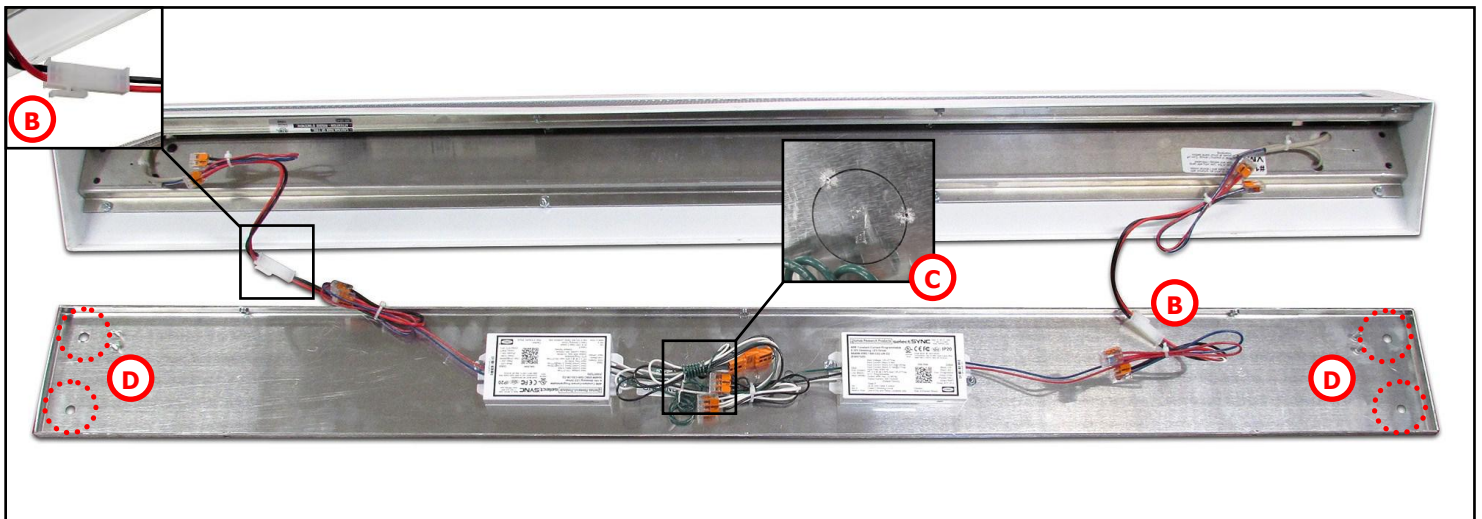
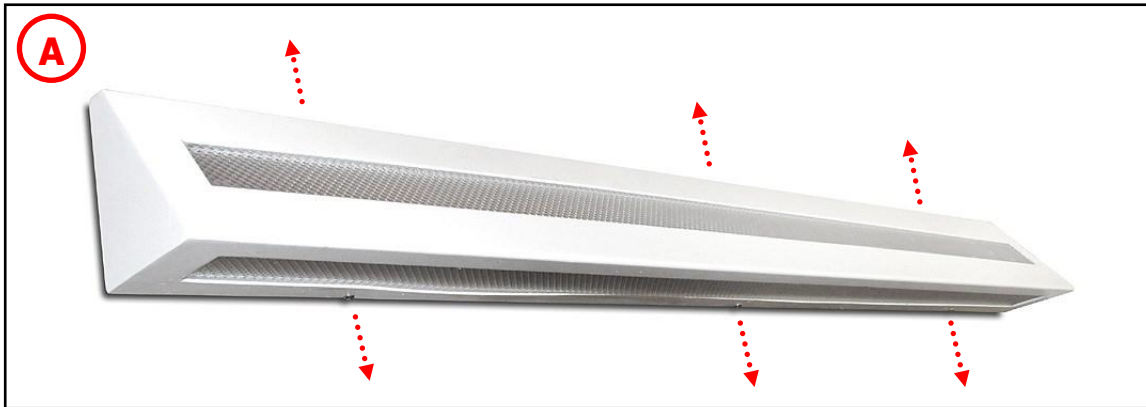

## **INSTALLATION STEPS**

1. Remove the tamperproof screws from the housing and lift the housing off the backplate. Set screws aside for future usage. (See Figure A)
2. Disconnect the wire connectors. (See Figure B)
3. Remove the knock-out for wire access entry. (See Figure C)
4. Take the backplate and mount it to the designated location on the wall using through the 4-mounting holes at the corners of the plate. (See Figure D) Note: Backplate Dimensions listed on Page 2.
5. Make the proper electrical connections through the knockout to the power supply in the wall. (See Figure C)
6. After connections have been made, reconnect the wire connectors. (See Figure B)
7. Re-install the housing using the screws from the first step to complete the installation. (See Figure A)

***Backplate Dimensions on Page 2***

Please be aware that these instructions do not claim to cover all particulars and variations in the equipment, procedure, or process described. Due to unforeseen circumstance during installation, operation or maintenance these instructions do not claim to provide directions for meeting every possibility. Please contact your nearest representative in a situation when additional information is required. We reserve the right to revise the design or components of any product due to parts availability or change in UL standards, without assuming any obligation or liability to modify any products previously manufactured and without notice. This literature depicts a product DESIGN that is the SOLE and EXCLUSIVE PROPERTY of CGF DESIGN, INC.—An Illinois Corporation. In compliance with U.S. COPYRIGHT and PATENT requirements, notification is hereby presented in this form that this literature, or the product it depicts, is NOT to be copied, altered or used in any manner without the express written consent of, or contrary to the best interests of, CGF DESIGN, INC.

## SAFETY INSTRUCTIONS

1. Disconnect main power before servicing luminaires.
2. Proper grounding is required to insure personal safety.
3. All work should be done by a qualified electrician.

## WARNING: RISK OF ELECTRIC SHOCK

Disconnect Power before starting installation or servicing luminaire.

## LEDGE BACKPLATE DIMENSIONS

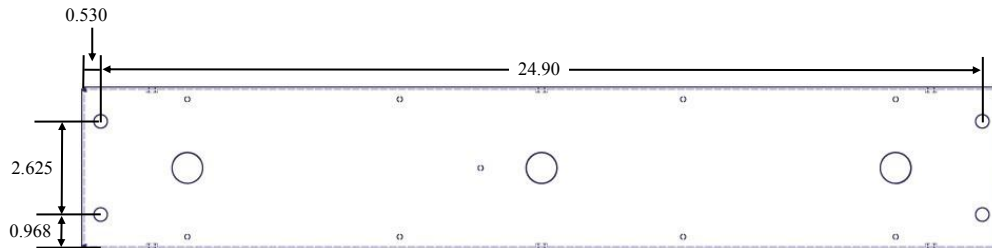

**LEDGE 2-FOOT**

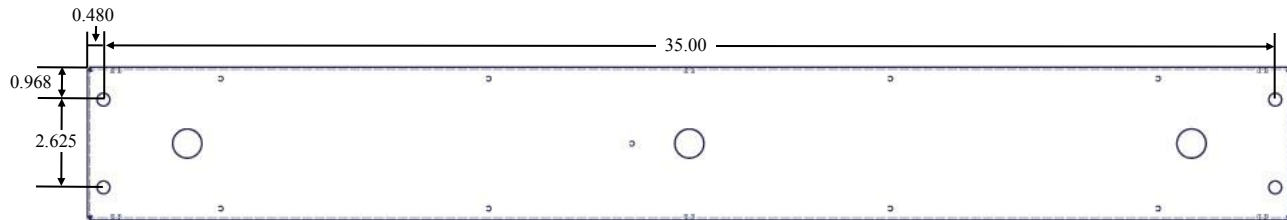

**LEDGE 3-FOOT**

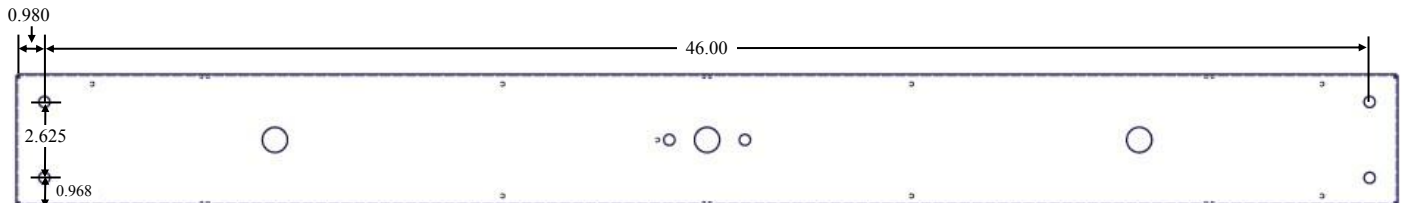

**LEDGE 4-FOOT**

Please be aware that these instructions do not claim to cover all particulars and variations in the equipment, procedure, or process described. Due to unforeseen circumstance during installation, operation or maintenance these instructions do not claim to provide directions for meeting every possibility. Please contact your nearest representative in a situation when additional information is required. We reserve the right to revise the design or components of any product due to parts availability or change in UL standards, without assuming any obligation or liability to modify any products previously manufactured and without notice. This literature depicts a product DESIGN that is the SOLE and EXCLUSIVE PROPERTY of CGF DESIGN, INC.—An Illinois Corporation. In compliance with U.S. COPYRIGHT and PATENT requirements, notification is hereby presented in this form that this literature, or the product it depicts, is NOT to be copied, altered or used in any manner without the express written consent of, or contrary to the best interests of, CGF DESIGN, INC.



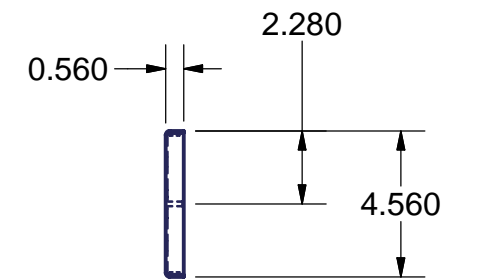
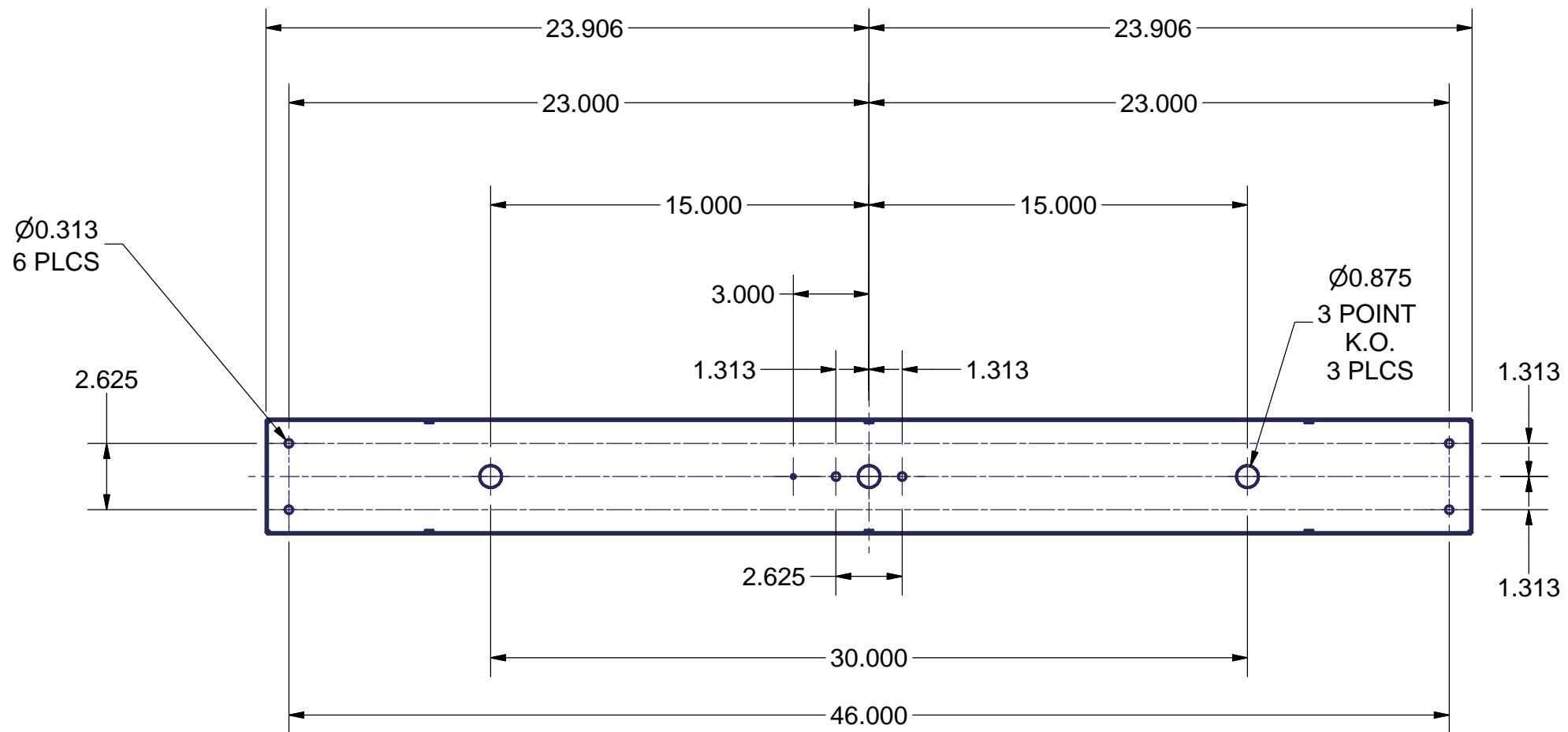
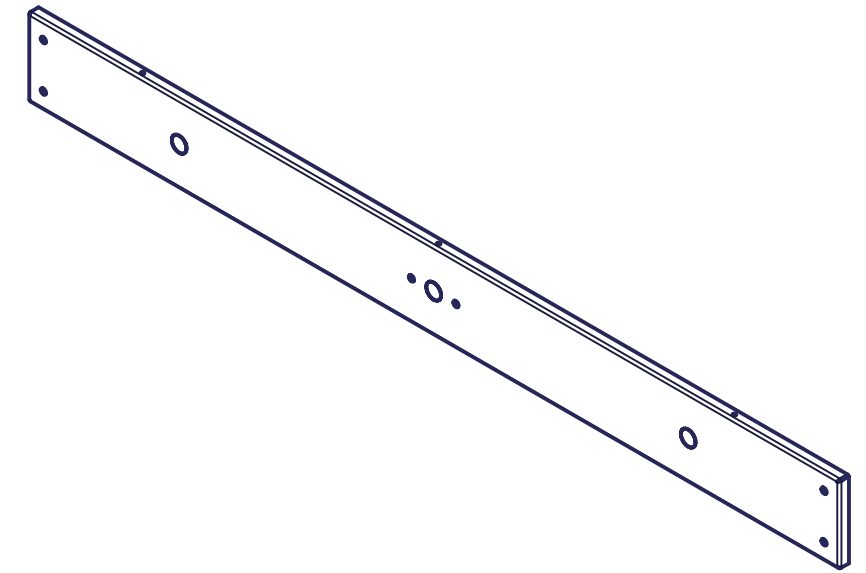
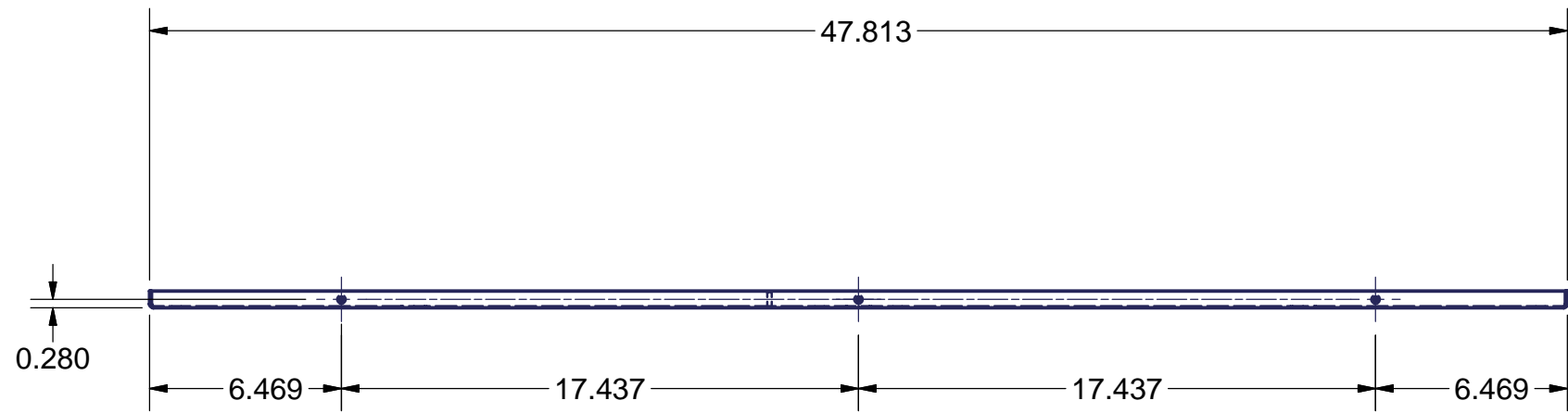

Material: .063" THCK ALUM  
 Thickness: .063" THCK ALUM  
 TOLERANCE UNLESS OTHERWISE SPECIFIED ALL DIMENSIONS IN INCHES  
 X.X ± 0.030  
 X.XX ± 0.015  
 X.XXX ± 0.010  
 ANGULAR ± 1'

**CGF design Inc.**  
 P.O. Box 911 Morton Grove, IL 60053  
 PHONE: (847) 815-5079 FAX: (847) 470-9828  
 PROPRIETARY INFORMATION  
 INFORMATION DISCLOSED HEREIN IS CONFIDENTIAL AND THE EXCLUSIVE PROPERTY OF CGF DESIGN INC. THIS DOCUMENT IS SUPPLIED FOR INFORMATION PURPOSES ONLY AND IS TO BE RETURNED PROMPTLY UPON REQUEST. ALL RIGHTS, PATENT AND OTHERWISE, ARE RETAINED BY CGF DESIGN, INC.

DESCRIPTION:  
 LEDGE MOUNTING PLATE  
 DRAWN BY: CMC DATE: 7/7/2017 CATALOG:  
 DRAWING NUMBER: PLAT0330 REV: D SHEET: 1 OF 1



BIDDING REQUIREMENTS for PURCHASING  
NOTICE AND INFORMATION FOR BIDDERS

**Attachment C: Scope of Work and Site Logistics**

Furnish and deliver lighting fixtures in two phases:

Phase 1: Delivery of 64 fixtures on or about July 15, 2022; and

Phase 2: Delivery of 60 fixtures by December 31, 2022.

Bidder is required to coordinate and schedule delivery with the point of contact provided on the purchase order.

The delivery address is:

University at Buffalo - South Campus  
Clement Hall  
1 Goodyear Road  
Buffalo, New York 14214