



**DASNY**

**ANDREW M. CUOMO**  
Governor

**ALFONSO L. CARNEY, JR.**  
Chair

**REUBEN R. MCDANIEL, III**  
Acting President & CEO

**Memorandum**

**TO:** Michael E. Cusack, Esq., General Counsel

**FROM:** Robert S. Derico, R. A., Director, Office of Environmental Affairs

**DATE:** April 3, 2020

**RE:** *State Environmental Quality Review (SEQR) Negative Declaration Concurrence for St. Lawrence-Lewis Counties Board of Cooperative Educational Services Renovations, Upgrades and Expansion at the Northwest, Southwest, and Seaway Area Technical Centers, St. Lawrence and Lewis Counties, New York*

St. Lawrence-Lewis Counties Board of Cooperative Educational Services (“SLL BOCES”) has requested financing from the Dormitory Authority of the State of New York (“DASNY”) for its *Renovations, Upgrades and Expansion at the Northwest, Southwest, and Seaway Area Technical Centers* (the “Proposed Project”). Based on a review of the attached *Transaction Summary Update*, dated March 27, 2020, it has been determined that the Proposed Action would involve DASNY’s authorization of the issuance of one or more series of fixed and/or variable rate, tax-exempt and/or taxable bonds in an amount not to exceed \$43,000,000 to be sold at one or more times through a negotiated offering on behalf of SLL BOCES are to be sold through a negotiated sale and/or private placement. The funding would be issued under DASNY’s BOCES Program.

*Description of the Institution.* The ability to create a Board of Cooperative Educational Services (“BOCES”) was first established in 1948 and is found in Section 1950 of the State Education Law. The legislation was designed to enable school districts to combine their resources to provide services that otherwise would have been uneconomical, inefficient or unavailable.

A BOCES is formed by the school districts of a supervisory district for the purpose of providing various educational services for such school districts on a cooperative or shared basis, which services may either be too expensive or duplicative for each school district to provide for itself. A BOCES is usually formed by an order of the Commissioner of Education after a petition has been made requesting the establishment of the BOCES by the respective Boards of Education of the various school districts to be included in the proposed BOCES. The decision to establish a BOCES is not subject to voter approval.

Section 1689 of the Public Authorities Law (the “Act”) authorizes DASNY, upon application from a BOCES, to construct, acquire, reconstruct and furnish and equip BOCES facilities. In addition, pursuant to the Act, DASNY is authorized to issue bonds and notes to obtain funds for the purposes of Section 1689.

SLL BOCES, established in 1970, provides shared services to 18 component school districts in St. Lawrence and Lewis counties that together serve approximately 20,000 students. SLL BOCES component school districts cover over 2,500 square miles in upstate New York. SLL BOCES administration offices are

located within the Village of Canton, St. Lawrence County. The renovations, upgrades and expansion work proposed would occur at the following SLL BOCES facilities: Northwest Technical Center (“NWTC”), 1000 Park Street, Ogdensburg, Southwest Technical Center (“SWTC”), 3606 State Highway 58, Gouverneur, and Seaway Area Technical Center (“SATC”) 7227 State Highway 56, Norwood. All are located within St. Lawrence County.

The school districts served by the three Technical Centers are as follows:

NWTC: Hammond, Hermon-DeKalb, Heuvelton, Lisbon, Madrid-Waddington, Morristown, and Ogdensburg.

SWTC: Clifton-Fine, Edwards-Knox, Gouverneur, and Harrisville.

SATC: Brasher Falls, Canton, Colton-Pierrepont, Massena, Norwood-Norfolk, Parishville-Hopkinton, and Potsdam.

*The Proposed Project.* The proposed bond issuance would finance these common components at all three Technical Centers: the upgrade and renovation of existing space to include improvements to the existing finishes, plumbing, heating, ventilation, and air conditioning (“HVAC”), and electrical systems. In addition, the proposed work would also include security improvements, including card access and controlled entrances, video surveillance and door and window hardening. Handicapped accessibility and Americans with Disabilities Act (“ADA”) improvements would also be included at the three facilities. Interior space modification or adjustments to meet educational program needs may also be contemplated.

Specific projects components to be financed at the individual technical center includes:

At NWTC: Construction of an approximately 7,000-square-foot addition to develop program space and new mechanical-electrical space and sitework to include drainage improvements, sidewalk replacement, paving and new exterior signage. The area of site disturbance is expected to be less than 1-acre in area.

At SWTC: Construction of an approximately 5,000-square-foot addition to develop program space and new mechanical-electrical space and sitework to include drainage improvements, sidewalk replacement, paving and new exterior signage. The area of site disturbance is expected to be less than 1-acre in area.

At SATC: Construction of an approximately 18,000-square-foot addition to develop new classrooms laboratory spaces, and necessary support spaces. Several existing buildings would also be demolished. Sitework would include possible connection to the existing municipal water system, drainage improvements, sidewalk replacement, paving and new exterior signage. The area of site disturbance is expected to be approximately 1 acre in area.

The Proposed Projects were the subject of a public referendum on October 9, 2018. Voters approved the measure by a vote of 992 in favor against 141 opposed.

*State Environmental Quality Review (“SEQR”).* DASNY conducted this environmental review in compliance with the *State Environmental Quality Review Act (“SEQRA”)*, codified at Article 8 of the *New York Environmental Conservation Law (“ECL”)*, and its implementing regulations, promulgated at Part 617 of Title 6 of the *New York Codes, Rules and Regulations (“N.Y.C.R.R.”)*, which collectively contain the requirements for the SEQR process. Representatives of DASNY reviewed the attached *Full Environmental Assessment Form – Part 1 (“EAF – Part 1”)* and supplemental information, completed on behalf of SLL BOCES by its consultant, MARCH Associates, Architects and Planners, dated June 11, 2018 for the Proposed Project.

The St. Lawrence-Lewis Board of Cooperative Educational Services, acting as lead agency, conducted a coordinated review of this Type I action, requesting comments from involved agencies and interested parties in the form of a Lead Agency Request Letter, dated June 20, 2018, for the Proposed Project. There being no objection to SLL BOCES acting as lead agency, SLL BOCES analyzed the potential impacts of the Proposed Project and issued its SEQR Resolution, which included its SEQR Negative Declaration - Notice of Determination of Non-Significance at its July 5<sup>th</sup>, 2018 Board of Education meeting (attached). The SLL BOCES noted within its SEQR Negative Declaration that “...*the proposed action will not have a significant environmental impact...*” While DASNY was not an involved agency for that coordinated SEQR process for the Proposed Project, it is bound by the determination of the lead agency.<sup>1</sup> DASNY discussed the Proposed Project’s possible environmental impacts with representatives of the applicant.

Based on the above, and the additional information set forth below, DASNY, as an involved agency, independently analyzed the relevant areas of environmental concern and concurs with the lead agency’s (“SLL BOCES’s”) SEQR determination that the proposed action will not have a significant effect on the environment.

*New York State Smart Growth Public Infrastructure Policy Act.* Since the Proposed Action would include DASNY bond financing, a *Smart Growth Impact Statement (“SGIS”)* for the Proposed Project was prepared pursuant to the *State of New York State Smart Growth Public Infrastructure Policy Act (“SSGPIPA”)* procedures (see “Smart Growth Impact Statement Assessment Form [“SGISAF”], attached). DASNY’s Smart Growth Advisory Committee reviewed the SGIS and attested that the Proposed Project, to the extent practicable, would meet the smart growth criteria established by the legislation. The compatibility of the Proposed Project with the ten criteria of the SSGPIPA, article 6 of the ECL, is detailed in the SGISAF. As indicated on the form, the Proposed Project would be generally supportive of the SSGPIPA and no further SSGPIPA analysis is required.

*New York State Historic Preservation Act of 1980 (“SHPA”) Determination.* Additionally, DASNY reviewed it in conformance with SHPA, especially the implementing regulations of section 14.09 of the *Parks, Recreation and Historic Preservation Law (“PRHPL”)*, as well as with the requirements of the Memorandum of Understanding (“MOU”), dated March 18, 1998, between the DASNY and the New York State Office of Parks, Recreation and Historic Preservation (“OPRHP”). MARCH Associates, based on the approvals needed from the New York State Education Department (“SED”), initiated consultation with OPRHP, the State Historic Preservation Office (“SHPO”) in New York State, regarding the Proposed Project (OPRHP Project Numbers. 19PR06814, 19PR06822, 19PR06831, 19PR06833, 19PR06834,). OPRHP, in its letters dated October 3, 2019, October 7, 2019, and October 21, 2019 (all attached), determined that “...*no properties, including archaeological and/or historic resources, listed in or eligible for the New York State and National Registers of Historic Places will be impacted by this project.*” It is the opinion of DASNY that the Proposed Project would have no impact on historical or cultural resources in or eligible for inclusion in the National and State Registers of Historic Places.

cc: Cheryl E. Sarjeant, Esq.  
Stephen J. Koiser  
SEQR File  
OPRHP File

---

<sup>1</sup> 6 N.Y.C.R.R. § 617.6(b)(3)(iii).

# Transaction Summary Update

St. Lawrence-Lewis Counties BOCES  
Master BOCES Program Lease Revenue Bonds

March 27, 2020

Program: BOCES

Purpose: New Money

## New Issue Details

One or more series of fixed and/or variable rate, tax-exempt and/or taxable bonds, in an amount not to exceed \$43,000,000 are to be sold at one or more times through a negotiated offering on behalf of St. Lawrence-Lewis Counties BOCES ("SLL BOCES").

- Lead Manager – Roosevelt & Cross Incorporated
- Underwriter's Counsel – Trespasz & Marquardt, LLP
- Bond Counsel – Bryant Rabbino LLP

### Purpose:

- Financing for capital projects at three career and technical education centers of SLL BOCES (\$43 million).

### Security:

- Annual rental payments to be made pursuant to a Lease Agreement(s) with SLL BOCES.
- Direct intercept, through the State Comptroller, of any State aid due SLL BOCES for rental payments on the DASNY Lease Agreement(s).
- Pledge of public funds apportioned by the State due to SLL BOCES in an amount sufficient to pay such rental payments, subordinate to pledges granted in connection with other outstanding SLL BOCES DASNY bonds.
- Debt Service Reserve Fund(s) and/or Reserve Fund Facility(ies) equal to one-half maximum annual debt service.
- Bond insurance may be considered depending on its availability and economic efficiency.

**Expected Rating:** Aa2/NR/NR

## Overview

The ability to create a Board of Cooperative Educational Services ("BOCES") was first established in 1948 and is found in Section 1950 of the State Education Law. The legislation was designed to enable school districts to combine their resources to provide services that otherwise would have been uneconomical, inefficient or unavailable.

A BOCES is formed by the school districts of a supervisory district for the purpose of providing various educational services for such school districts on a cooperative or shared basis, which services may either be too expensive or duplicative for each school district to provide for itself. A BOCES is usually formed by an order of the Commissioner of Education after a petition has been made requesting the establishment of the BOCES

by the respective Boards of Education of the various school districts to be included in the proposed BOCES. The decision to establish a BOCES is not subject to voter approval.

Section 1689 of the Public Authorities Law (the "Act") authorizes DASNY, upon application from a BOCES, to construct, acquire, reconstruct and furnish and equip BOCES facilities. In addition, pursuant to the Act, DASNY is authorized to issue bonds and notes to obtain funds for the purposes of Section 1689.

SLL BOCES, established in 1970, provides shared services to 18 component school districts in St. Lawrence and Lewis counties that together serve approximately 20,000 students. SLL BOCES component school districts cover over 2,500 square miles and the SLL BOCES administration offices are located in the Village of Canton.

## Description of the Bonds

- The bonds are a special obligation of DASNY.
- The bonds are payable from payments made by SLL BOCES under a Lease and Agreement(s) with DASNY and funds and accounts established under the Resolution.
- The Lease and Agreement(s) is a general obligation of SLL BOCES. Amounts received from the State pursuant to the direct payment mechanism are credited against the SLL BOCES payment obligations under the Lease and Agreement.

## Approvals

- Resolution to Proceed – November 13, 2019
- PACB Approval – November 20, 2019
- SEQR Filing – April 6, 2020\*

\*Anticipated date.

## Recent Information

The New York State Education Department issued the Certificate of Approvals for the projects being financed on March 3, 2020.

*This Transaction Summary Update was prepared solely to assist DASNY in its review and approval of the proposed financing described therein and must not be relied upon by any person for any other purpose. DASNY does not warrant the accuracy of the statements contained in any offering document or any other materials relating to or provided by the Institution in connection with the sale or offering of the Bonds, nor does it directly or indirectly guarantee, endorse or warrant (1) the creditworthiness or credit standing of the Institution, (2) the sufficiency of the security for the Bonds or (3) the value or investment quality of the Bonds.*



# Transaction Summary Update

---

St. Lawrence-Lewis Counties BOCES  
Master BOCES Program Lease Revenue Bonds

---

March 27, 2020

Program: BOCES

Purpose: New Money

---

*The Bonds are special limited obligations of DASNY that are secured only by the amounts required to be paid by the Institution pursuant to the Loan Agreement, certain funds established under the Resolution and other property, if any, pledged by the Institution as security for the Bonds.*



MASTER BOCES PROGRAM LEASE REVENUE BONDS  
ST. LAWRENCE – LEWIS ISSUE

The Letter from Bond Counsel will be transmitted to the Members under separate cover.

**Full Environmental Assessment Form  
Part 1 - Project and Setting**

**Instructions for Completing Part 1**

**Part 1 is to be completed by the applicant or project sponsor.** Responses become part of the application for approval or funding, are subject to public review, and may be subject to further verification.

Complete Part 1 based on information currently available. If additional research or investigation would be needed to fully respond to any item, please answer as thoroughly as possible based on current information; indicate whether missing information does not exist, or is not reasonably available to the sponsor; and, when possible, generally describe work or studies which would be necessary to update or fully develop that information.

Applicants/sponsors must complete all items in Sections A & B. In Sections C, D & E, most items contain an initial question that must be answered either "Yes" or "No". If the answer to the initial question is "Yes", complete the sub-questions that follow. If the answer to the initial question is "No", proceed to the next question. Section F allows the project sponsor to identify and attach any additional information. Section G requires the name and signature of the project sponsor to verify that the information contained in Part 1 is accurate and complete.

**A. Project and Sponsor Information.**

Name of Action or Project: <b>St. Lawrence-Lewis BOCES - Capital Project</b>		
Project Location (describe, and attach a general location map): <b>Work will be performed at the (3) Technical Centers (Refer to attached maps)</b>		
Brief Description of Proposed Action (include purpose or need): <b>Work is outlined by Site:  Northwest Technical Center (NWTC) Southwest Technical Center (SWTC) Seaway Area Technical Center (SATC)</b>  <b>Refer to attached sheet for description / action for each building. A partial site map shows the location of the three Technical Centers, aerial photographs of each site and a schematic floor plan.</b>		
Name of Applicant/Sponsor: <b>Thomas Burns, District Superintendent St. Lawrence-Lewis BOCES</b>		Telephone: <b>315.386-4504</b>
		E-Mail: <b>tburns@sllboces.org</b>
Address: <b>40 West Street</b>		
City/PO: <b>Canton</b>	State: <b>New York</b>	Zip Code: <b>13617</b>
Project Contact (if not same as sponsor; give name and title/role):	Telephone:	
	E-Mail:	
Address:		
City/PO:	State:	Zip Code:
Property Owner (if not same as sponsor):	Telephone:	
	E-Mail:	
Address:		
City/PO:	State:	Zip Code:

**B. Government Approvals**

<b>B. Government Approvals, Funding, or Sponsorship.</b> ("Funding" includes grants, loans, tax relief, and any other forms of financial assistance.)		
<b>Government Entity</b>	<b>If Yes: Identify Agency and Approval(s) Required</b>	<b>Application Date (Actual or projected)</b>
a. City Council, Town Board, <input type="checkbox"/> Yes <input type="checkbox"/> No or Village Board of Trustees		
b. City, Town or Village <input type="checkbox"/> Yes <input type="checkbox"/> No Planning Board or Commission		
c. City Council, Town or <input type="checkbox"/> Yes <input type="checkbox"/> No Village Zoning Board of Appeals		
d. Other local agencies <input type="checkbox"/> Yes <input type="checkbox"/> No		
e. County agencies <input checked="" type="checkbox"/> Yes <input type="checkbox"/> No	Department of Health	June 1 +/- 2020
f. Regional agencies <input type="checkbox"/> Yes <input type="checkbox"/> No		
g. State agencies <input checked="" type="checkbox"/> Yes <input type="checkbox"/> No	New State Education Department NYS - DEC SWPP	October 1 +/- 2019 Spring 2020
h. Federal agencies <input type="checkbox"/> Yes <input type="checkbox"/> No		
i. Coastal Resources.		
i. Is the project site within a Coastal Area, or the waterfront area of a Designated Inland Waterway?		<input type="checkbox"/> Yes <input checked="" type="checkbox"/> No
ii. Is the project site located in a community with an approved Local Waterfront Revitalization Program?		<input type="checkbox"/> Yes <input checked="" type="checkbox"/> No
iii. Is the project site within a Coastal Erosion Hazard Area?		<input type="checkbox"/> Yes <input checked="" type="checkbox"/> No

**C. Planning and Zoning**

<b>C.1. Planning and zoning actions.</b>	
Will administrative or legislative adoption, or amendment of a plan, local law, ordinance, rule or regulation be the only approval(s) which must be granted to enable the proposed action to proceed?	<input type="checkbox"/> Yes <input checked="" type="checkbox"/> No
<ul style="list-style-type: none"> <li>• <b>If Yes</b>, complete sections C, F and G.</li> <li>• <b>If No</b>, proceed to question C.2 and complete all remaining sections and questions in Part I</li> </ul>	
<b>C.2. Adopted land use plans.</b>	
a. Do any municipally- adopted (city, town, village or county) comprehensive land use plan(s) include the site where the proposed action would be located?	<input type="checkbox"/> Yes <input checked="" type="checkbox"/> No
If Yes, does the comprehensive plan include specific recommendations for the site where the proposed action would be located?	<input type="checkbox"/> Yes <input type="checkbox"/> No
b. Is the site of the proposed action within any local or regional special planning district (for example: Greenway Brownfield Opportunity Area (BOA); designated State or Federal heritage area; watershed management plan; or other?)	<input type="checkbox"/> Yes <input checked="" type="checkbox"/> No
If Yes, identify the plan(s):	
_____	
_____	
_____	
c. Is the proposed action located wholly or partially within an area listed in an adopted municipal open space plan, or an adopted municipal farmland protection plan?	<input type="checkbox"/> Yes <input checked="" type="checkbox"/> No
If Yes, identify the plan(s):	
_____	
_____	
_____	



**C.3. Zoning**

- a. Is the site of the proposed action located in a municipality with an adopted zoning law or ordinance.  Yes  No  
If Yes, what is the zoning classification(s) including any applicable overlay district?  
    NWTC, Ogdensburg - Business  
    SWTC, Gouverneur - No Zoning - Land Use Plan  
    SATC, Norwood - Residential - Agriculture
- b. Is the use permitted or allowed by a special or conditional use permit?  Yes  No
- c. Is a zoning change requested as part of the proposed action?  Yes  No  
If Yes,  
    i. What is the proposed new zoning for the site? \_\_\_\_\_

**C.4. Existing community services. Refer to the attached sheet**

- a. In what school district is the project site located? \_\_\_\_\_
- b. What police or other public protection forces serve the project site?  
\_\_\_\_\_
- c. Which fire protection and emergency medical services serve the project site?  
\_\_\_\_\_
- d. What parks serve the project site?  
\_\_\_\_\_  
\_\_\_\_\_

**D. Project Details**

**D.1. Proposed and Potential Development**

- a. What is the general nature of the proposed action (e.g., residential, industrial, commercial, recreational; if mixed, include all components)? **Refer to the attached sheet**  
\_\_\_\_\_
- b. a. Total acreage of the site of the proposed action? \_\_\_\_\_ acres  
    b. Total acreage to be physically disturbed? \_\_\_\_\_ acres  
    c. Total acreage (project site and any contiguous properties) owned or controlled by the applicant or project sponsor? \_\_\_\_\_ acres  
**Refer to the attached sheet**
- c. Is the proposed action an expansion of an existing project or use?  Yes  No  
    i. If Yes, what is the approximate percentage of the proposed expansion and identify the units (e.g., acres, miles, housing units, square feet)? % Refer to sheet Units: N.A.
- d. Is the proposed action a subdivision, or does it include a subdivision?  Yes  No  
If Yes,  
    i. Purpose or type of subdivision? (e.g., residential, industrial, commercial; if mixed, specify types)  
    ii. Is a cluster/conservation layout proposed?  Yes  No  
    iii. Number of lots proposed? \_\_\_\_\_  
    iv. Minimum and maximum proposed lot sizes? Minimum \_\_\_\_\_ Maximum \_\_\_\_\_
- e. Will proposed action be constructed in multiple phases?  Yes  No  
    i. If No, anticipated period of construction: 18 months  
    ii. If Yes:  
        • Total number of phases anticipated 3  
        • Anticipated commencement date of phase I (including demolition) 4 month 2020 year  
        • Anticipated completion date of final phase 9 month 2022 year  
        • Generally describe connections or relationships among phases, including any contingencies where progress of one phase may determine timing or duration of future phases: New spaces will be constructed to create required mechanical spaces and classrooms to be used as "Flex" spaces to allow renovation of existing spaces.

f. Does the project include new residential uses?  Yes  No

If Yes, show numbers of units proposed.

One Family      Two Family      Three Family      Multiple Family (four or more)

Initial Phase \_\_\_\_\_

At completion \_\_\_\_\_

of all phases \_\_\_\_\_

g. Does the proposed action include new non-residential construction (including expansions)? If Yes,  Yes  No

i. Total number of structures Additions at all three sites, largest at SATC.

ii. Dimensions (in feet) of largest proposed structure: 20 height; 120 +/-width; and 120 +/-length

iii. Approximate extent of building space to be heated or cooled: See Sheet \_\_\_\_\_ square feet

h. Does the proposed action include construction or other activities that will result in the impoundment of any liquids, such as creation of a water supply, reservoir, pond, lake, waste lagoon or other storage?  Yes  No

If Yes,

i. Purpose of the impoundment: \_\_\_\_\_

ii. If a water impoundment, the principal source of the water:  Ground water  Surface water streams  Other specify: \_\_\_\_\_

iii. If other than water, identify the type of impounded/contained liquids and their source. \_\_\_\_\_

iv. Approximate size of the proposed impoundment. Volume: \_\_\_\_\_ million gallons; surface area: \_\_\_\_\_ acres

v. Dimensions of the proposed dam or impounding structure: \_\_\_\_\_ height; \_\_\_\_\_ length

vi. Construction method/materials for the proposed dam or impounding structure (e.g., earth fill, rock, wood, concrete): \_\_\_\_\_

**D.2. Project Operations**

a. Does the proposed action include any excavation, mining, or dredging, during construction, operations, or both?  Yes  No (Not including general site preparation, grading or installation of utilities or foundations where all excavated materials will remain onsite)

If Yes:

i. What is the purpose of the excavation or dredging? \_\_\_\_\_

ii. How much material (including rock, earth, sediments, etc.) is proposed to be removed from the site?

• Volume (specify tons or cubic yards): \_\_\_\_\_

• Over what duration of time? \_\_\_\_\_

iii. Describe nature and characteristics of materials to be excavated or dredged, and plans to use, manage or dispose of them. \_\_\_\_\_

iv. Will there be onsite dewatering or processing of excavated materials?  Yes  No  
If yes, describe. \_\_\_\_\_

v. What is the total area to be dredged or excavated? \_\_\_\_\_ acres

vi. What is the maximum area to be worked at any one time? \_\_\_\_\_ acres

vii. What would be the maximum depth of excavation or dredging? \_\_\_\_\_ feet

viii. Will the excavation require blasting?  Yes  No

ix. Summarize site reclamation goals and plan: \_\_\_\_\_

b. Would the proposed action cause or result in alteration of, increase or decrease in size of, or encroachment into any existing wetland, waterbody, shoreline, beach or adjacent area?  Yes  No

If Yes:

i. Identify the wetland or waterbody which would be affected (by name, water index number, wetland map number or geographic description): \_\_\_\_\_

ii. Describe how the proposed action would affect that waterbody or wetland, e.g. excavation, fill, placement of structures, or alteration of channels, banks and shorelines. Indicate extent of activities, alterations and additions in square feet or acres:

\_\_\_\_\_  
\_\_\_\_\_  
\_\_\_\_\_

iii. Will proposed action cause or result in disturbance to bottom sediments?  Yes  No

If Yes, describe: \_\_\_\_\_

iv. Will proposed action cause or result in the destruction or removal of aquatic vegetation?  Yes  No

If Yes:

- acres of aquatic vegetation proposed to be removed: \_\_\_\_\_
- expected acreage of aquatic vegetation remaining after project completion: \_\_\_\_\_
- purpose of proposed removal (e.g. beach clearing, invasive species control, boat access): \_\_\_\_\_
- proposed method of plant removal: \_\_\_\_\_
- if chemical/herbicide treatment will be used, specify product(s): \_\_\_\_\_

v. Describe any proposed reclamation/mitigation following disturbance: \_\_\_\_\_

c. Will the proposed action use, or create a new demand for water?  Yes  No

If Yes:

i. Total anticipated water usage/demand per day: 1,000 +/- gallons/day

ii. Will the proposed action obtain water from an existing public water supply?  Yes  No

If Yes:

- Name of district or service area: Refer to attached Sheet
- Does the existing public water supply have capacity to serve the proposal? NWTC  Yes  No
- Is the project site in the existing district?  Yes  No
- Is expansion of the district needed?  Yes  No
- Do existing lines serve the project site? NWTC  Yes  No

iii. Will line extension within an existing district be necessary to supply the project?  Yes  No

If Yes:

- Describe extensions or capacity expansions proposed to serve this project: Extension of Municipal water main to Seaway Tech is desired, if arrangements with the Municipality can be made. Existing well is adequate to support expansion/demand.
- Source(s) of supply for the district: \_\_\_\_\_

iv. Is a new water supply district or service area proposed to be formed to serve the project site?  Yes  No

If, Yes:

- Applicant/sponsor for new district: \_\_\_\_\_
- Date application submitted or anticipated: \_\_\_\_\_
- Proposed source(s) of supply for new district: \_\_\_\_\_

v. If a public water supply will not be used, describe plans to provide water supply for the project: \_\_\_\_\_

vi. If water supply will be from wells (public or private), maximum pumping capacity: \_\_\_\_\_ gallons/minute.

d. Will the proposed action generate liquid wastes?  Yes  No

If Yes:

i. Total anticipated liquid waste generation per day: 1,000 +/- \* gallons/day

ii. Nature of liquid wastes to be generated (e.g., sanitary wastewater, industrial; if combination, describe all components and approximate volumes or proportions of each): Sanitary waste associated with additional toilet rooms

\*Waste is per site.

iii. Will the proposed action use any existing public wastewater treatment facilities?  Yes  No

If Yes:

- Name of wastewater treatment plant to be used: Ogdensburg and Norwood
- Name of district: \_\_\_\_\_
- Does the existing wastewater treatment plant have capacity to serve the project?  Yes  No
- Is the project site in the existing district?  Yes  No
- Is expansion of the district needed?  Yes  No

- Do existing sewer lines serve the project site? **NWTC and SATC**  Yes  No
- Will line extension within an existing district be necessary to serve the project?  Yes  No

If Yes: **SWTC has on-site waste disposal**

- Describe extensions or capacity expansions proposed to serve this project: \_\_\_\_\_  
\_\_\_\_\_

- iv. Will a new wastewater (sewage) treatment district be formed to serve the project site?  Yes  No
- If Yes:

- Applicant/sponsor for new district: \_\_\_\_\_
- Date application submitted or anticipated: \_\_\_\_\_
- What is the receiving water for the wastewater discharge? \_\_\_\_\_

- v. If public facilities will not be used, describe plans to provide wastewater treatment for the project, including specifying proposed receiving water (name and classification if surface discharge, or describe subsurface disposal plans):
- \_\_\_\_\_
- \_\_\_\_\_

- vi. Describe any plans or designs to capture, recycle or reuse liquid waste: \_\_\_\_\_  
\_\_\_\_\_

- e. Will the proposed action disturb more than one acre and create stormwater runoff, either from new point sources (i.e. ditches, pipes, swales, curbs, gutters or other concentrated flows of stormwater) or non-point source (i.e. sheet flow) during construction or post construction?  Yes  No

If Yes:

- i. How much impervious surface will the project create in relation to total size of project parcel?  
 \_\_\_\_\_ Square feet or \_\_\_\_\_ \* acres (impervious surface) \*NWTC >1 ac, SWTC >1 ac, SATC 4 +/- ac  
 \_\_\_\_\_ Square feet or \_\_\_\_\_ acres (parcel size)

- ii. Describe types of new point sources. Roof drains and additional paved surfaces

- iii. Where will the stormwater runoff be directed (i.e. on-site stormwater management facility/structures, adjacent properties, groundwater, on-site surface water or off-site surface waters)?

On-site storm water management systems / structures

- If to surface waters, identify receiving water bodies or wetlands: \_\_\_\_\_  
\_\_\_\_\_
- Will stormwater runoff flow to adjacent properties?  Yes  No

- iv. Does proposed plan minimize impervious surfaces, use pervious materials or collect and re-use stormwater?  Yes  No

- f. Does the proposed action include, or will it use on-site, one or more sources of air emissions, including fuel combustion, waste incineration, or other processes or operations?  Yes  No

If Yes, identify:

- i. Mobile sources during project operations (e.g., heavy equipment, fleet or delivery vehicles)

- ii. Stationary sources during construction (e.g., power generation, structural heating, batch plant, crushers)

Possible welding booth exhaust

- iii. Stationary sources during operations (e.g., process emissions, large boilers, electric generation)

- g. Will any air emission sources named in D.2.f (above), require a NY State Air Registration, Air Facility Permit, or Federal Clean Air Act Title IV or Title V Permit?  Yes  No

If Yes:

- i. Is the project site located in an Air quality non-attainment area? (Area routinely or periodically fails to meet ambient air quality standards for all or some parts of the year)  Yes  No

- ii. In addition to emissions as calculated in the application, the project will generate:

- \_\_\_\_\_ Tons/year (short tons) of Carbon Dioxide (CO<sub>2</sub>)
- \_\_\_\_\_ Tons/year (short tons) of Nitrous Oxide (N<sub>2</sub>O)
- \_\_\_\_\_ Tons/year (short tons) of Perfluorocarbons (PFCs)
- \_\_\_\_\_ Tons/year (short tons) of Sulfur Hexafluoride (SF<sub>6</sub>)
- \_\_\_\_\_ Tons/year (short tons) of Carbon Dioxide equivalent of Hydroflouorocarbons (HFCs)
- \_\_\_\_\_ Tons/year (short tons) of Hazardous Air Pollutants (HAPs)

h. Will the proposed action generate or emit methane (including, but not limited to, sewage treatment plants, landfills, composting facilities)?  Yes  No

If Yes:

- i. Estimate methane generation in tons/year (metric): \_\_\_\_\_
- ii. Describe any methane capture, control or elimination measures included in project design (e.g., combustion to generate heat or electricity, flaring): \_\_\_\_\_

i. Will the proposed action result in the release of air pollutants from open-air operations or processes, such as quarry or landfill operations?  Yes  No

If Yes: Describe operations and nature of emissions (e.g., diesel exhaust, rock particulates/dust): \_\_\_\_\_

j. Will the proposed action result in a substantial increase in traffic above present levels or generate substantial new demand for transportation facilities or services?  Yes  No

If Yes:

- i. When is the peak traffic expected (Check all that apply):  Morning  Evening  Weekend  
 Randomly between hours of \_\_\_\_\_ to \_\_\_\_\_.
- ii. For commercial activities only, projected number of semi-trailer truck trips/day: \_\_\_\_\_
- iii. Parking spaces: Existing \_\_\_\_\_ Proposed \_\_\_\_\_ Net increase/decrease \_\_\_\_\_
- iv. Does the proposed action include any shared use parking?  Yes  No
- v. If the proposed action includes any modification of existing roads, creation of new roads or change in existing access, describe: \_\_\_\_\_
- vi. Are public/private transportation service(s) or facilities available within 1/2 mile of the proposed site?  Yes  No
- vii. Will the proposed action include access to public transportation or accommodations for use of hybrid, electric or other alternative fueled vehicles?  Yes  No
- viii. Will the proposed action include plans for pedestrian or bicycle accommodations for connections to existing pedestrian or bicycle routes?  Yes  No

k. Will the proposed action (for commercial or industrial projects only) generate new or additional demand for energy?  Yes  No

If Yes:

- i. Estimate annual electricity demand during operation of the proposed action: \_\_\_\_\_
- ii. Anticipated sources/suppliers of electricity for the project (e.g., on-site combustion, on-site renewable, via grid/local utility, or other): \_\_\_\_\_
- iii. Will the proposed action require a new, or an upgrade to, an existing substation?  Yes  No

l. Hours of operation. Answer all items which apply.

i. During Construction:

- Monday - Friday: 7:00 AM - 10:00 PM
- Saturday: \_\_\_\_\_
- Sunday: \_\_\_\_\_
- Holidays: \_\_\_\_\_

ii. During Operations:

- Monday - Friday: 7:00 AM - 10:00 PM
- Saturday: \_\_\_\_\_
- Sunday: \_\_\_\_\_
- Holidays: \_\_\_\_\_

m. Will the proposed action produce noise that will exceed existing ambient noise levels during construction, operation, or both?  Yes  No

If yes:

i. Provide details including sources, time of day and duration:  
**Noise associated with construction is anticipated at all locations.**

ii. Will proposed action remove existing natural barriers that could act as a noise barrier or screen?  Yes  No  
Describe: \_\_\_\_\_

---

n. Will the proposed action have outdoor lighting?  Yes  No

If yes:

i. Describe source(s), location(s), height of fixture(s), direction/aim, and proximity to nearest occupied structures:  
**New LED lighting will be included, lighting will include building and site lighting. Lighting will be designed to not affect adjacent properties.**

ii. Will proposed action remove existing natural barriers that could act as a light barrier or screen?  Yes  No  
Describe: \_\_\_\_\_

---

o. Does the proposed action have the potential to produce odors for more than one hour per day?  Yes  No  
If Yes, describe possible sources, potential frequency and duration of odor emissions, and proximity to nearest occupied structures: \_\_\_\_\_

---

p. Will the proposed action include any bulk storage of petroleum (combined capacity of over 1,100 gallons) or chemical products 185 gallons in above ground storage or any amount in underground storage?  Yes  No

If Yes:

i. Product(s) to be stored \_\_\_\_\_

ii. Volume(s) \_\_\_\_\_ per unit time \_\_\_\_\_ (e.g., month, year)

iii. Generally describe proposed storage facilities: \_\_\_\_\_

---

q. Will the proposed action (commercial, industrial and recreational projects only) use pesticides (i.e., herbicides, insecticides) during construction or operation?  Yes  No

If Yes:

i. Describe proposed treatment(s): \_\_\_\_\_

ii. Will the proposed action use Integrated Pest Management Practices?  Yes  No

---

r. Will the proposed action (commercial or industrial projects only) involve or require the management or disposal of solid waste (excluding hazardous materials)?  Yes  No

If Yes:

i. Describe any solid waste(s) to be generated during construction or operation of the facility:

- Construction: 3 tons per week (unit of time)
- Operation : >1 tons per week (unit of time)

ii. Describe any proposals for on-site minimization, recycling or reuse of materials to avoid disposal as solid waste:

- Construction: Metals and cardboard will be recycled during construction.
- Operation: \_\_\_\_\_

iii. Proposed disposal methods/facilities for solid waste generated on-site:

- Construction: Local approved landfills and shipped to Rodman.
- Operation: Local approved landfills and shipped to Rodman.

s. Does the proposed action include construction or modification of a solid waste management facility?  Yes  No

If Yes:

- i. Type of management or handling of waste proposed for the site (e.g., recycling or transfer station, composting, landfill, or other disposal activities): \_\_\_\_\_
- ii. Anticipated rate of disposal/processing:
  - \_\_\_\_\_ Tons/month, if transfer or other non-combustion/thermal treatment, or
  - \_\_\_\_\_ Tons/hour, if combustion or thermal treatment
- iii. If landfill, anticipated site life: \_\_\_\_\_ years

t. Will proposed action at the site involve the commercial generation, treatment, storage, or disposal of hazardous waste?  Yes  No

If Yes:

- i. Name(s) of all hazardous wastes or constituents to be generated, handled or managed at facility: \_\_\_\_\_  
**Possible disposal of asbestos containing materials**
- ii. Generally describe processes or activities involving hazardous wastes or constituents: \_\_\_\_\_  
**VAT abatement**
- iii. Specify amount to be handled or generated 5 tons/month (total)
- iv. Describe any proposals for on-site minimization, recycling or reuse of hazardous constituents: \_\_\_\_\_  
**None**

v. Will any hazardous wastes be disposed at an existing offsite hazardous waste facility?  Yes  No

If Yes: provide name and location of facility: **To be determined. Material will be shipped to an approved landfill**

If No: describe proposed management of any hazardous wastes which will not be sent to a hazardous waste facility:

### E. Site and Setting of Proposed Action

#### E.1. Land uses on and surrounding the project site

a. Existing land uses.

i. Check all uses that occur on, adjoining and near the project site.

- Urban  Industrial  Commercial  Residential (suburban)  Rural (non-farm)  
 Forest  Agriculture  Aquatic  Other (specify): \_\_\_\_\_

ii. If mix of uses, generally describe:

b. Land uses and covertypes on the project site.

Land use or Covertype	Current Acreage	Acreage After Project Completion	Change (Acres +/-)
• Roads, buildings, and other paved or impervious surfaces	NWTC - 4+/-, SWTC - 3+/- SATC - 4	NWTC - 4.5+/-, SWTC - 3.2 SATC - 6	NWTC - .5, SWTC - .2 SATC - 2
• Forested	SWTC - 5+/-, SATC - 10+/-	SWTC - 5+/-, SATC - 10+/-	SWTC - 0, SATC - 0
• Meadows, grasslands or brushlands (non-agricultural, including abandoned agricultural)	NWTC - 10+/- SWTC - 10+/-	NWTC - 10+/- SWTC - 10+/-	NWTC - 0 SWTC - 0
• Agricultural (includes active orchards, field, greenhouse etc.)	None	None	None
• Surface water features (lakes, ponds, streams, rivers, etc.)	SWTC - 2	SWTC - 2	SWTC - 0
• Wetlands (freshwater or tidal)	None	None	0
• Non-vegetated (bare rock, earth or fill)	None	None	0
• Other Describe: _____			

c. Is the project site presently used by members of the community for public recreation?  Yes  No

i. If Yes: explain: \_\_\_\_\_

d. Are there any facilities serving children, the elderly, people with disabilities (e.g., schools, hospitals, licensed day care centers, or group homes) within 1500 feet of the project site?  Yes  No

If Yes,  
i. Identify Facilities:  
All facilities serve as BOCES Facilities

e. Does the project site contain an existing dam?  Yes  No

If Yes:  
i. Dimensions of the dam and impoundment:  
• Dam height: \_\_\_\_\_ feet  
• Dam length: \_\_\_\_\_ feet  
• Surface area: \_\_\_\_\_ acres  
• Volume impounded: \_\_\_\_\_ gallons OR acre-feet  
ii. Dam's existing hazard classification: \_\_\_\_\_  
iii. Provide date and summarize results of last inspection: \_\_\_\_\_

f. Has the project site ever been used as a municipal, commercial or industrial solid waste management facility, or does the project site adjoin property which is now, or was at one time, used as a solid waste management facility?  Yes  No

If Yes:  
i. Has the facility been formally closed?  Yes  No  
• If yes, cite sources/documentation: \_\_\_\_\_  
ii. Describe the location of the project site relative to the boundaries of the solid waste management facility: \_\_\_\_\_  
iii. Describe any development constraints due to the prior solid waste activities: \_\_\_\_\_

g. Have hazardous wastes been generated, treated and/or disposed of at the site, or does the project site adjoin property which is now or was at one time used to commercially treat, store and/or dispose of hazardous waste?  Yes  No

If Yes:  
i. Describe waste(s) handled and waste management activities, including approximate time when activities occurred: \_\_\_\_\_

h. Potential contamination history. Has there been a reported spill at the proposed project site, or have any remedial actions been conducted at or adjacent to the proposed site?  Yes  No

If Yes:  
i. Is any portion of the site listed on the NYSDEC Spills Incidents database or Environmental Site Remediation database? Check all that apply:  Yes  No  
 Yes – Spills Incidents database Provide DEC ID number(s): \_\_\_\_\_  
 Yes – Environmental Site Remediation database Provide DEC ID number(s): \_\_\_\_\_  
 Neither database

ii. If site has been subject of RCRA corrective activities, describe control measures: \_\_\_\_\_

iii. Is the project within 2000 feet of any site in the NYSDEC Environmental Site Remediation database?  Yes  No

If yes, provide DEC ID number(s): \_\_\_\_\_  
iv. If yes to (i), (ii) or (iii) above, describe current status of site(s): \_\_\_\_\_



v. Is the project site subject to an institutional control limiting property uses?  Yes  No

- If yes, DEC site ID number: \_\_\_\_\_
- Describe the type of institutional control (e.g., deed restriction or easement): \_\_\_\_\_
- Describe any use limitations: \_\_\_\_\_
- Describe any engineering controls: \_\_\_\_\_
- Will the project affect the institutional or engineering controls in place?  Yes  No
- Explain: \_\_\_\_\_

**E.2. Natural Resources On or Near Project Site**

a. What is the average depth to bedrock on the project site? Unknown, varies from site feet

b. Are there bedrock outcroppings on the project site?  Yes  No  
 If Yes, what proportion of the site is comprised of bedrock outcroppings? \_\_\_\_\_ %

c. Predominant soil type(s) present on project site: Glacial Till & Sand Loam \_\_\_\_\_ % Varies from site to  
 \_\_\_\_\_ % site  
 \_\_\_\_\_ %

d. What is the average depth to the water table on the project site? Average: \_\_\_\_\_ feet

e. Drainage status of project site soils:  Well Drained: \_\_\_\_\_ % of site  
 Moderately Well Drained: 100 % of site  
 Poorly Drained \_\_\_\_\_ % of site

f. Approximate proportion of proposed action site with slopes:  0-10%: 100 % of site  
 10-15%: \_\_\_\_\_ % of site  
 15% or greater: \_\_\_\_\_ % of site

g. Are there any unique geologic features on the project site?  Yes  No  
 If Yes, describe: \_\_\_\_\_

h. Surface water features.

i. Does any portion of the project site contain wetlands or other waterbodies (including streams, rivers, ponds or lakes)?  Yes  No

ii. Do any wetlands or other waterbodies adjoin the project site?  Yes  No  
 If Yes to either *i* or *ii*, continue. If No, skip to E.2.i.

iii. Are any of the wetlands or waterbodies within or adjoining the project site regulated by any federal, state or local agency?  Yes  No

iv. For each identified regulated wetland and waterbody on the project site, provide the following information:

- Streams: Name \_\_\_\_\_ Classification \_\_\_\_\_
- Lakes or Ponds: Name \_\_\_\_\_ Classification \_\_\_\_\_
- Wetlands: Name \_\_\_\_\_ Approximate Size \_\_\_\_\_
- Wetland No. (if regulated by DEC) \_\_\_\_\_

v. Are any of the above water bodies listed in the most recent compilation of NYS water quality-impaired waterbodies?  Yes  No  
 If yes, name of impaired water body/bodies and basis for listing as impaired: \_\_\_\_\_

i. Is the project site in a designated Floodway?  Yes  No

j. Is the project site in the 100 year Floodplain?  Yes  No

k. Is the project site in the 500 year Floodplain?  Yes  No

l. Is the project site located over, or immediately adjoining, a primary, principal or sole source aquifer?  Yes  No  
 If Yes:  
 i. Name of aquifer: \_\_\_\_\_

m. Identify the predominant wildlife species that occupy or use the project site: \_\_\_\_\_

White tail deer \* \_\_\_\_\_ Turkey \* \_\_\_\_\_

Woodchuck \* \_\_\_\_\_

\* All three sites \_\_\_\_\_

---

n. Does the project site contain a designated significant natural community?  Yes  No

If Yes:

*i.* Describe the habitat/community (composition, function, and basis for designation): \_\_\_\_\_

\_\_\_\_\_

*ii.* Source(s) of description or evaluation: \_\_\_\_\_

*iii.* Extent of community/habitat:

- Currently: \_\_\_\_\_ acres
- Following completion of project as proposed: \_\_\_\_\_ acres
- Gain or loss (indicate + or -): \_\_\_\_\_ acres

---

o. Does project site contain any species of plant or animal that is listed by the federal government or NYS as endangered or threatened, or does it contain any areas identified as habitat for an endangered or threatened species?  Yes  No

NWTC - Bald Eagle

---

p. Does the project site contain any species of plant or animal that is listed by NYS as rare, or as a species of special concern?  Yes  No

---

q. Is the project site or adjoining area currently used for hunting, trapping, fishing or shell fishing?  Yes  No

If yes, give a brief description of how the proposed action may affect that use: \_\_\_\_\_

\_\_\_\_\_

---

**E.3. Designated Public Resources On or Near Project Site**

a. Is the project site, or any portion of it, located in a designated agricultural district certified pursuant to Agriculture and Markets Law, Article 25-AA, Section 303 and 304?  Yes  No

If Yes, provide county plus district name/number: \_\_\_\_\_

---

b. Are agricultural lands consisting of highly productive soils present?  Yes  No

*i.* If Yes: acreage(s) on project site? \_\_\_\_\_

*ii.* Source(s) of soil rating(s): \_\_\_\_\_

---

c. Does the project site contain all or part of, or is it substantially contiguous to, a registered National Natural Landmark?  Yes  No

If Yes:

*i.* Nature of the natural landmark:  Biological Community  Geological Feature

*ii.* Provide brief description of landmark, including values behind designation and approximate size/extent: \_\_\_\_\_

\_\_\_\_\_

---

d. Is the project site located in or does it adjoin a state listed Critical Environmental Area?  Yes  No

If Yes:

*i.* CEA name: \_\_\_\_\_

*ii.* Basis for designation: \_\_\_\_\_

*iii.* Designating agency and date: \_\_\_\_\_

e. Does the project site contain, or is it substantially contiguous to, a building, archaeological site, or district which is listed on, or has been nominated by the NYS Board of Historic Preservation for inclusion on, the State or National Register of Historic Places?  Yes  No

If Yes:  
 i. Nature of historic/archaeological resource:  Archaeological Site  Historic Building or District  
 ii. Name: \_\_\_\_\_  
 iii. Brief description of attributes on which listing is based: \_\_\_\_\_

---

f. Is the project site, or any portion of it, located in or adjacent to an area designated as sensitive for archaeological sites on the NY State Historic Preservation Office (SHPO) archaeological site inventory?  Yes  No

---

g. Have additional archaeological or historic site(s) or resources been identified on the project site?  Yes  No

If Yes:  
 i. Describe possible resource(s): \_\_\_\_\_  
 ii. Basis for identification: \_\_\_\_\_

---

h. Is the project site within five miles of any officially designated and publicly accessible federal, state, or local scenic or aesthetic resource?  Yes  No

If Yes:  
 i. Identify resource: \_\_\_\_\_  
 ii. Nature of, or basis for, designation (e.g., established highway overlook, state or local park, state historic trail or scenic byway, etc.): \_\_\_\_\_  
 iii. Distance between project and resource: \_\_\_\_\_ miles.

---

i. Is the project site located within a designated river corridor under the Wild, Scenic and Recreational Rivers Program 6 NYCRR 666?  Yes  No

If Yes:  
 i. Identify the name of the river and its designation: \_\_\_\_\_  
 ii. Is the activity consistent with development restrictions contained in 6NYCRR Part 666?  Yes  No

**F. Additional Information**

Attach any additional information which may be needed to clarify your project.

If you have identified any adverse impacts which could be associated with your proposal, please describe those impacts plus any measures which you propose to avoid or minimize them.

**G. Verification**

I certify that the information provided is true to the best of my knowledge.

Applicant/Sponsor Name Thomas Burns

Date 6/11/18

Signature

Title District Superintendent

**Full Environmental Assessment Form - Part 1**

**A. Project and Sponsor Information**

**Brief Description of Proposed Action:**

**Northwest Technical Center (NWTC)**, located at 1000 Park Street, Ogdensburg, NY 13669.

Work will include upgrade / renovation of existing spaces. Upgrades will include improvements to existing finishes, plumbing, HVAC and electrical systems. Security improvements, including card access, controlled entrances, video surveillance and door / window hardening is envisioned. Overall handicapped access will also be included to address ADA compliance.

Interior spaces may be modified or adjusted to meet educational program needs. Work may include construction of up to 7,000 square foot addition to develop program space and new mechanical / electrical spaces.

Sitework will include drainage improvements, sidewalk replacement, paving and new exterior signage. Disturbance is less than 1 acre.

**Southwest Technical Center (SWTC)**, located at 3606 State Highway 58, Gouverneur, NY 13642.

Work will include upgrade / renovation of existing spaces. Upgrades will include improvements to existing finishes, plumbing, HVAC and electrical systems. Security improvements, including card access, controlled entrances, video surveillance and door / window hardening is envisioned. Overall handicapped access will also be included to address ADA compliance.

Interior spaces may be modified or adjusted to meet educational program needs. Work may include construction of up to 5,000 square foot addition to develop program space and new mechanical / electrical spaces.

Sitework will include drainage improvements, sidewalk replacement, paving and new exterior signage. Disturbance is less than 1 acre.

**Seaway Area Technical Center (SATC)**, located at 7227 State Highway 56, Norwood, NY 13668.

Work will include upgrade / renovation of existing spaces. Upgrades will include improvements to existing finishes, plumbing, HVAC and electrical systems. Security improvements, including card access, controlled entrances, video surveillance and door / window hardening is envisioned. Overall handicapped access will also be included to address ADA compliance.

Interior spaces may be modified or adjusted to meet educational program needs. Work may include construction of an approximately 18,000 square foot addition(s) to develop new classrooms, lab spaces and necessary support spaces. Several existing buildings will also be demolished.

Sitework will include possible connections to the Municipal Water System (if feasible), drainage improvements, sidewalk replacement, paving and new exterior signage. Disturbance will be approximately 1 acre.

#### **C.4. Existing Community Services**

**NWTC is served by the following School Districts:**

Hammond, Hermon-DeKalb, Heuvelton, Lisbon, Madrid-Waddington, Morristown and Ogdensburg.

**SWTC is served by the following School Districts:**

Clifton-Fine, Edwards-Knox, Gouverneur and Harrisville

**SATC is served by the following School Districts:**

Brasher Falls, Canton, Colton-Pierrepont, Massena, Norwood-Norfolk, Parishville-Hopkinton and Potsdam

a. In what school district is the project located?

NWTC – Ogdensburg Central School District

SWTC – Gouverneur Central School District

SATC – Norwood-Norfolk Central School District

b. What police or other public protection forces serve the project site?

All buildings are served by the New York State Police Department. NWTC by the Ogdensburg City Police, SATC also served by the St. Lawrence Sheriff's Department. SWTC is also served by the St. Lawrence Sheriff's Department.

c. Which fire protection and emergency medical services serve the project site?

NWTC is served by the City of Ogdensburg Fire Department.

SWTC is served by the Gouverneur Fire Department.

SATC is served by the Norwood Fire Department.

Various ambulance services handle emergency calls at the three sites.

d. what parks serve the project site?

A number of parks are located near the various BOCES Facilities.

#### **D.1. Proposed and Potential Development**

a. What is the general nature of the proposed action?

The project includes the construction of additional educational and support spaces at the NWTC, SWTC and SATC sites. Several existing buildings on the SATC site will be demolished. Project to support the new construction is also included.

b. Total acreage of the site of the proposed action? (Broken down by building)

NWTC

a. 41.25 acres

b. >acres

c. 41.25 acres

SWTC

a. 44.3 acres

b. >1 acres

c. 44.3 acres

SATC

a. 56.3 acres

b. 4± acres

c. 56.3 acres

c.i. Is the proposed action an expansion of an existing project or use? By %

NWTC – 8%

SWTC – 10%

SATC – 38%

g.iii. Approximate extent of building space to be heated or cooled:

NWTC – 65,300

SWTC – 45,600

SATC – 64,500

c. Will the proposed action use, or create a new demand for water?

c.ii. Name of district or Service area:

NWTC – City of Ogdensburg

SWTC – On Site Well

SATC – On Site Well

\* \* \* \* \*

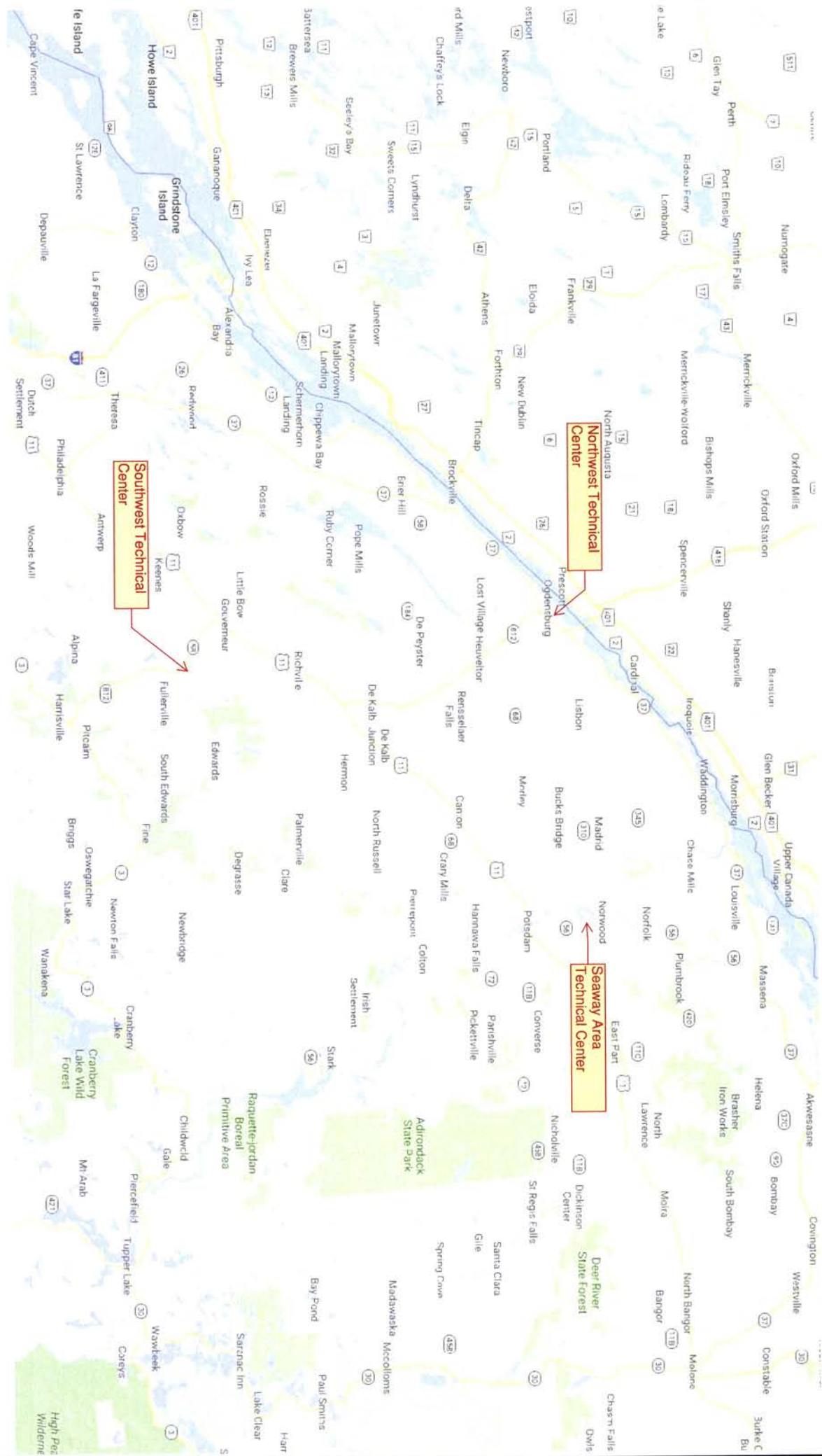



Google

River Side Dr

Lake Shore Dr

Lake Shore Dr

BOCES Seaway  
Tech Campus

Seaway Area Tech Center

Fosters Truck &  
Equipment Repair

Potter's Industries

River Side Rd









**OVERALL FLOOR PLAN**  
 SCALE: 1/8" = 1'-0"

SOIL REMEDIATION: FT. MONK REVISIONS: DATE: MAR 28, 2018 DRAWN BY: [Name] CHECKED BY: [Name] SCALE: 1/8" = 1'-0" PROJECT NO.: 1801 DRAWING TITLE: <b>FLOOR PLAN</b>	<b>SK-1</b> DRAWING NO.
---	----------------------------

**ST. LAWRENCE-LEWIS BOCES  
 SEAWAY AREA TECH CENTER  
 CAPITAL PROJECT**  
 NORWOOD, NEW YORK

**MARCHE ASSOCIATES**  
 ARCHITECTS  
 285 Federal Street, 4th Floor  
 New York, NY 10038  
 Phone: 212-693-9300  
 Fax: 212-693-9301  
 www.marche.com

PREPARED BY: [Name]  
 CHECKED BY: [Name]  
 DATE: [Date]  
 PROJECT NO.: [Number]



Boces Southwest Tech

Artist Wilson Bickford

Tripp Fuel

Little York Rd  
Tripp Fuels

Automated Cash Technologies

Farm To Market Rd

Google

Little York Rd

Emeryville Rd

Emeryville Rd

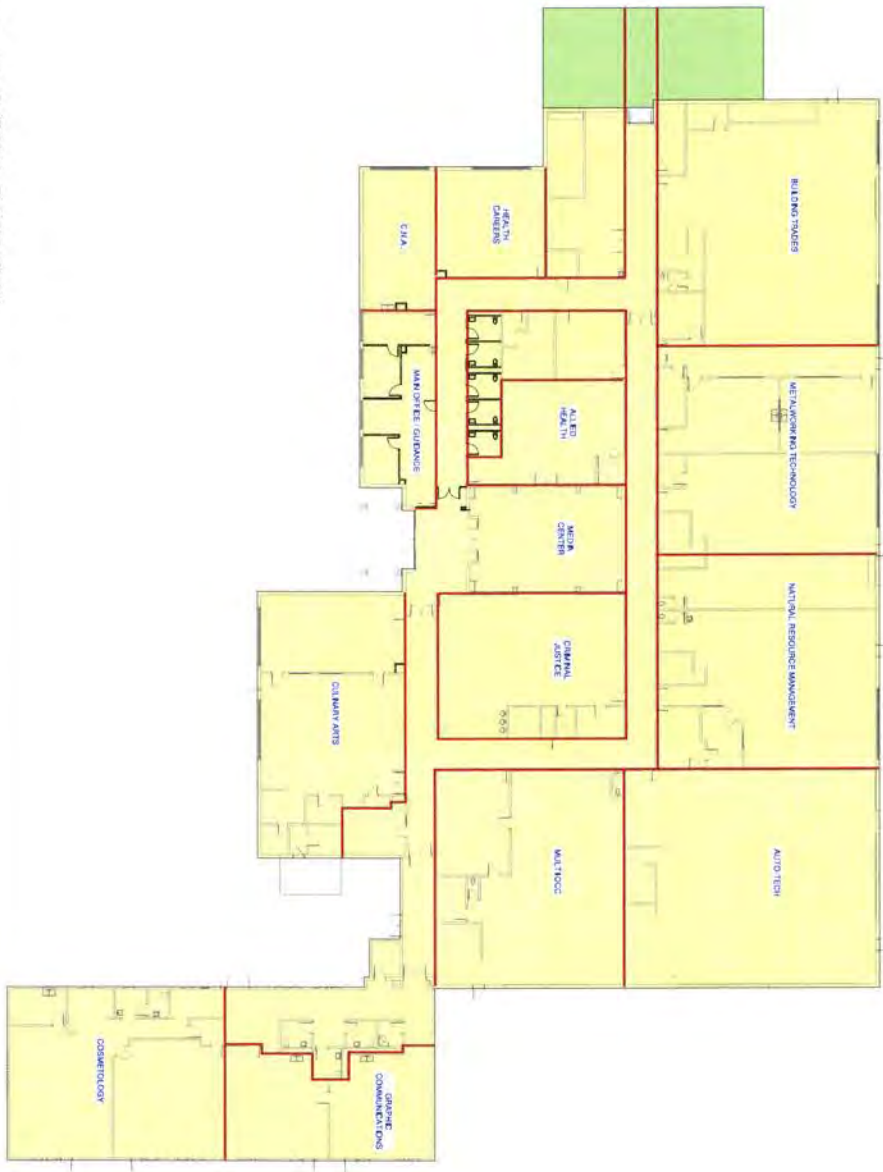



**OVERALL FLOOR PLAN**  
 SCALE 1/8" = 1'-0"

NO.	DESCRIPTION	DATE
1	ISSUED FOR PERMIT	04/22/2021
2	REVISIONS	
3	DATE	04/22/2021
4	DRAWN BY	MS
5	CHECKED BY	MS
6	SCALE	1/8" = 1'-0"
7	PROJECT NO.	19021
8	DRAWING TITLE	FLOOR PLAN

**ST. LAWRENCE-LEWIS BOCES**  
**SOUTHWEST TECH CENTER**  
**CAPITAL PROJECT**  
 FOWLER, NEW YORK

**MARCH ASSOCIATES**  
 ARCHITECTS  
 201 Federal Street, 3rd Fl.  
 Newburgh, NY 12551  
 Phone: 845-562-1144  
 Fax: 845-562-1144  
 www.march-associates.com

DRAWING NO.  
**SK-2**



Google

Tim Hortons

Perry's Beverage Center

OVERALL FLOOR PLAN  
SCALE: 1/8" = 1'-0"



DATE	DESCRIPTION	BY	DATE
04/25/2023			
REVISIONS			
DATE	DESCRIPTION	BY	DATE
04/25/2023			
DRAWN BY			
CHECKED BY			
SCALE			
PROJECT NO.			
DRAWING TITLE			

**ST. LAWRENCE-LEWIS BOCES**  
**NORTHWEST TECH CENTER**  
**CAPITAL PROJECT**  
 OGDENSBURG, NEW YORK

2023 General Building, 10/10/23  
 10/10/23  
 10/10/23  
 10/10/23  
 10/10/23



DRAWING NO.  
**SK-3**

**Full Environmental Assessment Form**  
**Part 2 - Identification of Potential Project Impacts**

Project : \_\_\_\_\_

Date : \_\_\_\_\_

**Part 2 is to be completed by the lead agency.** Part 2 is designed to help the lead agency inventory all potential resources that could be affected by a proposed project or action. We recognize that the lead agency's reviewer(s) will not necessarily be environmental professionals. So, the questions are designed to walk a reviewer through the assessment process by providing a series of questions that can be answered using the information found in Part 1. To further assist the lead agency in completing Part 2, the form identifies the most relevant questions in Part 1 that will provide the information needed to answer the Part 2 question. When Part 2 is completed, the lead agency will have identified the relevant environmental areas that may be impacted by the proposed activity.

If the lead agency is a state agency **and** the action is in any Coastal Area, complete the Coastal Assessment Form before proceeding with this assessment.

**Tips for completing Part 2:**

- Review all of the information provided in Part 1.
- Review any application, maps, supporting materials and the Full EAF Workbook.
- Answer each of the 18 questions in Part 2.
- If you answer "Yes" to a numbered question, please complete all the questions that follow in that section.
- If you answer "No" to a numbered question, move on to the next numbered question.
- Check appropriate column to indicate the anticipated size of the impact.
- Proposed projects that would exceed a numeric threshold contained in a question should result in the reviewing agency checking the box "Moderate to large impact may occur."
- The reviewer is not expected to be an expert in environmental analysis.
- If you are not sure or undecided about the size of an impact, it may help to review the sub-questions for the general question and consult the workbook.
- When answering a question consider all components of the proposed activity, that is, the "whole action".
- Consider the possibility for long-term and cumulative impacts as well as direct impacts.
- Answer the question in a reasonable manner considering the scale and context of the project.

<b>1. Impact on Land</b> Proposed action may involve construction on, or physical alteration of, the land surface of the proposed site. (See Part 1, D.1) <i>If "Yes", answer questions a - j. If "No", move on to Section 2.</i>			
		<input type="checkbox"/> NO	<input checked="" type="checkbox"/> YES
	Relevant Part I Question(s)	No, or small impact may occur	Moderate to large impact may occur
a. The proposed action may involve construction on land where depth to water table is less than 3 feet.	E2d	<input checked="" type="checkbox"/>	<input type="checkbox"/>
b. The proposed action may involve construction on slopes of 15% or greater.	E2f	<input checked="" type="checkbox"/>	<input type="checkbox"/>
c. The proposed action may involve construction on land where bedrock is exposed, or generally within 5 feet of existing ground surface.	E2a	<input checked="" type="checkbox"/>	<input type="checkbox"/>
d. The proposed action may involve the excavation and removal of more than 1,000 tons of natural material.	D2a	<input checked="" type="checkbox"/>	<input type="checkbox"/>
e. The proposed action may involve construction that continues for more than one year or in multiple phases.	D1e	<input checked="" type="checkbox"/>	<input type="checkbox"/>
f. The proposed action may result in increased erosion, whether from physical disturbance or vegetation removal (including from treatment by herbicides).	D2e, D2q	<input checked="" type="checkbox"/>	<input type="checkbox"/>
g. The proposed action is, or may be, located within a Coastal Erosion hazard area.	B1i	<input checked="" type="checkbox"/>	<input type="checkbox"/>
h. Other impacts: _____ _____		<input type="checkbox"/>	<input type="checkbox"/>

**2. Impact on Geological Features**

The proposed action may result in the modification or destruction of, or inhibit access to, any unique or unusual land forms on the site (e.g., cliffs, dunes, minerals, fossils, caves). (See Part 1. E.2.g)

NO

YES

*If "Yes", answer questions a - c. If "No", move on to Section 3.*

	Relevant Part I Question(s)	No, or small impact may occur	Moderate to large impact may occur
a. Identify the specific land form(s) attached: _____	E2g	<input type="checkbox"/>	<input type="checkbox"/>
b. The proposed action may affect or is adjacent to a geological feature listed as a registered National Natural Landmark. Specific feature: _____	E3c	<input type="checkbox"/>	<input type="checkbox"/>
c. Other impacts: _____		<input type="checkbox"/>	<input type="checkbox"/>

**3. Impacts on Surface Water**

The proposed action may affect one or more wetlands or other surface water bodies (e.g., streams, rivers, ponds or lakes). (See Part 1. D.2, E.2.h)

NO

YES

*If "Yes", answer questions a - l. If "No", move on to Section 4.*

	Relevant Part I Question(s)	No, or small impact may occur	Moderate to large impact may occur
a. The proposed action may create a new water body.	D2b, D1h	<input type="checkbox"/>	<input type="checkbox"/>
b. The proposed action may result in an increase or decrease of over 10% or more than a 10 acre increase or decrease in the surface area of any body of water.	D2b	<input type="checkbox"/>	<input type="checkbox"/>
c. The proposed action may involve dredging more than 100 cubic yards of material from a wetland or water body.	D2a	<input type="checkbox"/>	<input type="checkbox"/>
d. The proposed action may involve construction within or adjoining a freshwater or tidal wetland, or in the bed or banks of any other water body.	E2h	<input type="checkbox"/>	<input type="checkbox"/>
e. The proposed action may create turbidity in a waterbody, either from upland erosion, runoff or by disturbing bottom sediments.	D2a, D2h	<input type="checkbox"/>	<input type="checkbox"/>
f. The proposed action may include construction of one or more intake(s) for withdrawal of water from surface water.	D2c	<input type="checkbox"/>	<input type="checkbox"/>
g. The proposed action may include construction of one or more outfall(s) for discharge of wastewater to surface water(s).	D2d	<input type="checkbox"/>	<input type="checkbox"/>
h. The proposed action may cause soil erosion, or otherwise create a source of stormwater discharge that may lead to siltation or other degradation of receiving water bodies.	D2e	<input type="checkbox"/>	<input type="checkbox"/>
i. The proposed action may affect the water quality of any water bodies within or downstream of the site of the proposed action.	E2h	<input type="checkbox"/>	<input type="checkbox"/>
j. The proposed action may involve the application of pesticides or herbicides in or around any water body.	D2q, E2h	<input type="checkbox"/>	<input type="checkbox"/>
k. The proposed action may require the construction of new, or expansion of existing, wastewater treatment facilities.	D1a, D2d	<input type="checkbox"/>	<input type="checkbox"/>

l. Other impacts: _____ _____		<input type="checkbox"/>	<input type="checkbox"/>
----------------------------------	--	--------------------------	--------------------------

**4. Impact on groundwater**

The proposed action may result in new or additional use of ground water, or may have the potential to introduce contaminants to ground water or an aquifer.

NO

YES

(See Part 1. D.2.a, D.2.c, D.2.d, D.2.p, D.2.q, D.2.t)

*If "Yes", answer questions a - h. If "No", move on to Section 5.*

	Relevant Part I Question(s)	No, or small impact may occur	Moderate to large impact may occur
a. The proposed action may require new water supply wells, or create additional demand on supplies from existing water supply wells.	D2c	<input checked="" type="checkbox"/>	<input type="checkbox"/>
b. Water supply demand from the proposed action may exceed safe and sustainable withdrawal capacity rate of the local supply or aquifer. Cite Source: _____	D2c	<input checked="" type="checkbox"/>	<input type="checkbox"/>
c. The proposed action may allow or result in residential uses in areas without water and sewer services.	D1a, D2c	<input checked="" type="checkbox"/>	<input type="checkbox"/>
d. The proposed action may include or require wastewater discharged to groundwater.	D2d, E2l	<input checked="" type="checkbox"/>	<input type="checkbox"/>
e. The proposed action may result in the construction of water supply wells in locations where groundwater is, or is suspected to be, contaminated.	D2c, E1f, E1g, E1h	<input checked="" type="checkbox"/>	<input type="checkbox"/>
f. The proposed action may require the bulk storage of petroleum or chemical products over ground water or an aquifer.	D2p, E2l	<input checked="" type="checkbox"/>	<input type="checkbox"/>
g. The proposed action may involve the commercial application of pesticides within 100 feet of potable drinking water or irrigation sources.	E2h, D2q, E2l, D2c	<input checked="" type="checkbox"/>	<input type="checkbox"/>
h. Other impacts: _____ _____		<input type="checkbox"/>	<input type="checkbox"/>

**5. Impact on Flooding**

The proposed action may result in development on lands subject to flooding.

NO

YES

(See Part 1. E.2)

*If "Yes", answer questions a - g. If "No", move on to Section 6.*

	Relevant Part I Question(s)	No, or small impact may occur	Moderate to large impact may occur
a. The proposed action may result in development in a designated floodway.	E2i	<input type="checkbox"/>	<input type="checkbox"/>
b. The proposed action may result in development within a 100 year floodplain.	E2j	<input type="checkbox"/>	<input type="checkbox"/>
c. The proposed action may result in development within a 500 year floodplain.	E2k	<input type="checkbox"/>	<input type="checkbox"/>
d. The proposed action may result in, or require, modification of existing drainage patterns.	D2b, D2e	<input type="checkbox"/>	<input type="checkbox"/>
e. The proposed action may change flood water flows that contribute to flooding.	D2b, E2i, E2j, E2k	<input type="checkbox"/>	<input type="checkbox"/>
f. If there is a dam located on the site of the proposed action, is the dam in need of repair, or upgrade?	E1e	<input type="checkbox"/>	<input type="checkbox"/>



g. Other impacts: _____		<input type="checkbox"/>	<input type="checkbox"/>
-------------------------	--	--------------------------	--------------------------

**6. Impacts on Air**  
 The proposed action may include a state regulated air emission source.  NO  YES  
 (See Part 1. D.2.f., D,2,h, D.2.g)  
*If "Yes", answer questions a - f. If "No", move on to Section 7.*

	Relevant Part I Question(s)	No, or small impact may occur	Moderate to large impact may occur
a. If the proposed action requires federal or state air emission permits, the action may also emit one or more greenhouse gases at or above the following levels: i. More than 1000 tons/year of carbon dioxide (CO <sub>2</sub> ) ii. More than 3.5 tons/year of nitrous oxide (N <sub>2</sub> O) iii. More than 1000 tons/year of carbon equivalent of perfluorocarbons (PFCs) iv. More than .045 tons/year of sulfur hexafluoride (SF <sub>6</sub> ) v. More than 1000 tons/year of carbon dioxide equivalent of hydrochloroflouorocarbons (HFCs) emissions vi. 43 tons/year or more of methane	D2g D2g D2g D2g D2g D2h	<input type="checkbox"/> <input type="checkbox"/> <input type="checkbox"/> <input type="checkbox"/> <input type="checkbox"/> <input type="checkbox"/>	<input type="checkbox"/> <input type="checkbox"/> <input type="checkbox"/> <input type="checkbox"/> <input type="checkbox"/> <input type="checkbox"/>
b. The proposed action may generate 10 tons/year or more of any one designated hazardous air pollutant, or 25 tons/year or more of any combination of such hazardous air pollutants.	D2g	<input type="checkbox"/>	<input type="checkbox"/>
c. The proposed action may require a state air registration, or may produce an emissions rate of total contaminants that may exceed 5 lbs. per hour, or may include a heat source capable of producing more than 10 million BTU's per hour.	D2f, D2g	<input type="checkbox"/>	<input type="checkbox"/>
d. The proposed action may reach 50% of any of the thresholds in "a" through "c", above.	D2g	<input type="checkbox"/>	<input type="checkbox"/>
e. The proposed action may result in the combustion or thermal treatment of more than 1 ton of refuse per hour.	D2s	<input type="checkbox"/>	<input type="checkbox"/>
f. Other impacts: _____		<input type="checkbox"/>	<input type="checkbox"/>

**7. Impact on Plants and Animals**  
 The proposed action may result in a loss of flora or fauna. (See Part 1. E.2. m.-q.)  NO  YES  
*If "Yes", answer questions a - j. If "No", move on to Section 8.*

	Relevant Part I Question(s)	No, or small impact may occur	Moderate to large impact may occur
a. The proposed action may cause reduction in population or loss of individuals of any threatened or endangered species, as listed by New York State or the Federal government, that use the site, or are found on, over, or near the site.	E2o	<input type="checkbox"/>	<input type="checkbox"/>
b. The proposed action may result in a reduction or degradation of any habitat used by any rare, threatened or endangered species, as listed by New York State or the federal government.	E2o	<input type="checkbox"/>	<input type="checkbox"/>
c. The proposed action may cause reduction in population, or loss of individuals, of any species of special concern or conservation need, as listed by New York State or the Federal government, that use the site, or are found on, over, or near the site.	E2p	<input type="checkbox"/>	<input type="checkbox"/>
d. The proposed action may result in a reduction or degradation of any habitat used by any species of special concern and conservation need, as listed by New York State or the Federal government.	E2p	<input type="checkbox"/>	<input type="checkbox"/>

e. The proposed action may diminish the capacity of a registered National Natural Landmark to support the biological community it was established to protect.	E3c	<input type="checkbox"/>	<input type="checkbox"/>
f. The proposed action may result in the removal of, or ground disturbance in, any portion of a designated significant natural community. Source: _____	E2n	<input type="checkbox"/>	<input type="checkbox"/>
g. The proposed action may substantially interfere with nesting/breeding, foraging, or over-wintering habitat for the predominant species that occupy or use the project site.	E2m	<input type="checkbox"/>	<input type="checkbox"/>
h. The proposed action requires the conversion of more than 10 acres of forest, grassland or any other regionally or locally important habitat. Habitat type & information source: _____	E1b	<input type="checkbox"/>	<input type="checkbox"/>
i. Proposed action (commercial, industrial or recreational projects, only) involves use of herbicides or pesticides.	D2q	<input type="checkbox"/>	<input type="checkbox"/>
j. Other impacts: _____		<input type="checkbox"/>	<input type="checkbox"/>

**8. Impact on Agricultural Resources**

The proposed action may impact agricultural resources. (See Part 1. E.3.a. and b.)

NO

YES

*If "Yes", answer questions a - h. If "No", move on to Section 9.*

	Relevant Part I Question(s)	No, or small impact may occur	Moderate to large impact may occur
a. The proposed action may impact soil classified within soil group 1 through 4 of the NYS Land Classification System.	E2c, E3b	<input type="checkbox"/>	<input type="checkbox"/>
b. The proposed action may sever, cross or otherwise limit access to agricultural land (includes cropland, hayfields, pasture, vineyard, orchard, etc).	E1a, E1b	<input type="checkbox"/>	<input type="checkbox"/>
c. The proposed action may result in the excavation or compaction of the soil profile of active agricultural land.	E3b	<input type="checkbox"/>	<input type="checkbox"/>
d. The proposed action may irreversibly convert agricultural land to non-agricultural uses, either more than 2.5 acres if located in an Agricultural District, or more than 10 acres if not within an Agricultural District.	E1b, E3a	<input type="checkbox"/>	<input type="checkbox"/>
e. The proposed action may disrupt or prevent installation of an agricultural land management system.	E1 a, E1b	<input type="checkbox"/>	<input type="checkbox"/>
f. The proposed action may result, directly or indirectly, in increased development potential or pressure on farmland.	C2c, C3, D2c, D2d	<input type="checkbox"/>	<input type="checkbox"/>
g. The proposed project is not consistent with the adopted municipal Farmland Protection Plan.	C2c	<input type="checkbox"/>	<input type="checkbox"/>
h. Other impacts: _____		<input type="checkbox"/>	<input type="checkbox"/>

**9. Impact on Aesthetic Resources**

The land use of the proposed action are obviously different from, or are in sharp contrast to, current land use patterns between the proposed project and a scenic or aesthetic resource. (Part 1. E.1.a, E.1.b, E.3.h.)

NO

YES

*If "Yes", answer questions a - g. If "No", go to Section 10.*

	Relevant Part I Question(s)	No, or small impact may occur	Moderate to large impact may occur
a. Proposed action may be visible from any officially designated federal, state, or local scenic or aesthetic resource.	E3h	<input type="checkbox"/>	<input type="checkbox"/>
b. The proposed action may result in the obstruction, elimination or significant screening of one or more officially designated scenic views.	E3h, C2b	<input type="checkbox"/>	<input type="checkbox"/>
c. The proposed action may be visible from publicly accessible vantage points: i. Seasonally (e.g., screened by summer foliage, but visible during other seasons) ii. Year round	E3h	<input type="checkbox"/> <input type="checkbox"/>	<input type="checkbox"/> <input type="checkbox"/>
d. The situation or activity in which viewers are engaged while viewing the proposed action is: i. Routine travel by residents, including travel to and from work ii. Recreational or tourism based activities	E3h E2q, E1c	<input type="checkbox"/> <input type="checkbox"/>	<input type="checkbox"/> <input type="checkbox"/>
e. The proposed action may cause a diminishment of the public enjoyment and appreciation of the designated aesthetic resource.	E3h	<input type="checkbox"/>	<input type="checkbox"/>
f. There are similar projects visible within the following distance of the proposed project: 0-1/2 mile 1/2 -3 mile 3-5 mile 5+ mile	D1a, E1a, D1f, D1g	<input type="checkbox"/>	<input type="checkbox"/>
g. Other impacts: _____ _____		<input type="checkbox"/>	<input type="checkbox"/>

**10. Impact on Historic and Archeological Resources**

The proposed action may occur in or adjacent to a historic or archaeological resource. (Part 1. E.3.e, f. and g.)

NO

YES

*If "Yes", answer questions a - e. If "No", go to Section 11.*

	Relevant Part I Question(s)	No, or small impact may occur	Moderate to large impact may occur
a. The proposed action may occur wholly or partially within, or substantially contiguous to, any buildings, archaeological site or district which is listed on or has been nominated by the NYS Board of Historic Preservation for inclusion on the State or National Register of Historic Places.	E3e	<input type="checkbox"/>	<input type="checkbox"/>
b. The proposed action may occur wholly or partially within, or substantially contiguous to, an area designated as sensitive for archaeological sites on the NY State Historic Preservation Office (SHPO) archaeological site inventory.	E3f	<input type="checkbox"/>	<input type="checkbox"/>
c. The proposed action may occur wholly or partially within, or substantially contiguous to, an archaeological site not included on the NY SHPO inventory. Source: _____	E3g	<input type="checkbox"/>	<input type="checkbox"/>

d. Other impacts: _____		<input type="checkbox"/>	<input type="checkbox"/>
e. If any of the above (a-d) are answered "Moderate to large impact may occur", continue with the following questions to help support conclusions in Part 3:			
i. The proposed action may result in the destruction or alteration of all or part of the site or property.	E3e, E3g, E3f	<input type="checkbox"/>	<input type="checkbox"/>
ii. The proposed action may result in the alteration of the property's setting or integrity.	E3e, E3f, E3g, E1a, E1b	<input type="checkbox"/>	<input type="checkbox"/>
iii. The proposed action may result in the introduction of visual elements which are out of character with the site or property, or may alter its setting.	E3e, E3f, E3g, E3h, C2, C3	<input type="checkbox"/>	<input type="checkbox"/>

**11. Impact on Open Space and Recreation**

The proposed action may result in a loss of recreational opportunities or a reduction of an open space resource as designated in any adopted municipal open space plan.

NO

YES

(See Part 1. C.2.c, E.1.c., E.2.q.)

If "Yes", answer questions a - e. If "No", go to Section 12.

	Relevant Part I Question(s)	No, or small impact may occur	Moderate to large impact may occur
a. The proposed action may result in an impairment of natural functions, or "ecosystem services", provided by an undeveloped area, including but not limited to stormwater storage, nutrient cycling, wildlife habitat.	D2e, E1b E2h, E2m, E2o, E2n, E2p	<input type="checkbox"/>	<input type="checkbox"/>
b. The proposed action may result in the loss of a current or future recreational resource.	C2a, E1c, C2c, E2q	<input type="checkbox"/>	<input type="checkbox"/>
c. The proposed action may eliminate open space or recreational resource in an area with few such resources.	C2a, C2c E1c, E2q	<input type="checkbox"/>	<input type="checkbox"/>
d. The proposed action may result in loss of an area now used informally by the community as an open space resource.	C2c, E1c	<input type="checkbox"/>	<input type="checkbox"/>
e. Other impacts: _____		<input type="checkbox"/>	<input type="checkbox"/>

**12. Impact on Critical Environmental Areas**

The proposed action may be located within or adjacent to a critical environmental area (CEA). (See Part 1, E.3.d)

NO

YES

If "Yes", answer questions a - c. If "No", go to Section 13.

	Relevant Part I Question(s)	No, or small impact may occur	Moderate to large impact may occur
a. The proposed action may result in a reduction in the quantity of the resource or characteristic which was the basis for designation of the CEA.	E3d	<input type="checkbox"/>	<input type="checkbox"/>
b. The proposed action may result in a reduction in the quality of the resource or characteristic which was the basis for designation of the CEA.	E3d	<input type="checkbox"/>	<input type="checkbox"/>
c. Other impacts: _____		<input type="checkbox"/>	<input type="checkbox"/>

**13. Impact on Transportation**

The proposed action may result in a change to existing transportation systems.

 NO YES

(See Part 1. D.2.j)

*If "Yes", answer questions a - f. If "No", go to Section 14.*

	Relevant Part I Question(s)	No, or small impact may occur	Moderate to large impact may occur
a. Projected traffic increase may exceed capacity of existing road network.	D2j	<input type="checkbox"/>	<input type="checkbox"/>
b. The proposed action may result in the construction of paved parking area for 500 or more vehicles.	D2j	<input type="checkbox"/>	<input type="checkbox"/>
c. The proposed action will degrade existing transit access.	D2j	<input type="checkbox"/>	<input type="checkbox"/>
d. The proposed action will degrade existing pedestrian or bicycle accommodations.	D2j	<input type="checkbox"/>	<input type="checkbox"/>
e. The proposed action may alter the present pattern of movement of people or goods.	D2j	<input type="checkbox"/>	<input type="checkbox"/>
f. Other impacts: _____ _____		<input type="checkbox"/>	<input type="checkbox"/>

**14. Impact on Energy**

The proposed action may cause an increase in the use of any form of energy.

 NO YES

(See Part 1. D.2.k)

*If "Yes", answer questions a - e. If "No", go to Section 15.*

	Relevant Part I Question(s)	No, or small impact may occur	Moderate to large impact may occur
a. The proposed action will require a new, or an upgrade to an existing, substation.	D2k	<input checked="" type="checkbox"/>	<input type="checkbox"/>
b. The proposed action will require the creation or extension of an energy transmission or supply system to serve more than 50 single or two-family residences or to serve a commercial or industrial use.	D1f, D1q, D2k	<input checked="" type="checkbox"/>	<input type="checkbox"/>
c. The proposed action may utilize more than 2,500 MWhrs per year of electricity.	D2k	<input checked="" type="checkbox"/>	<input type="checkbox"/>
d. The proposed action may involve heating and/or cooling of more than 100,000 square feet of building area when completed.	D1g	<input checked="" type="checkbox"/>	<input type="checkbox"/>
e. Other Impacts: _____ _____		<input type="checkbox"/>	<input type="checkbox"/>

**15. Impact on Noise, Odor, and Light**

The proposed action may result in an increase in noise, odors, or outdoor lighting.

 NO YES

(See Part 1. D.2.m., n., and o.)

*If "Yes", answer questions a - f. If "No", go to Section 16.*

	Relevant Part I Question(s)	No, or small impact may occur	Moderate to large impact may occur
a. The proposed action may produce sound above noise levels established by local regulation.	D2m	<input checked="" type="checkbox"/>	<input type="checkbox"/>
b. The proposed action may result in blasting within 1,500 feet of any residence, hospital, school, licensed day care center, or nursing home.	D2m, E1d	<input checked="" type="checkbox"/>	<input type="checkbox"/>
c. The proposed action may result in routine odors for more than one hour per day.	D2o	<input checked="" type="checkbox"/>	<input type="checkbox"/>

d. The proposed action may result in light shining onto adjoining properties.	D2n	<input checked="" type="checkbox"/>	<input type="checkbox"/>
e. The proposed action may result in lighting creating sky-glow brighter than existing area conditions.	D2n, E1a	<input checked="" type="checkbox"/>	<input type="checkbox"/>
f. Other impacts: _____		<input type="checkbox"/>	<input type="checkbox"/>

**16. Impact on Human Health**  
 The proposed action may have an impact on human health from exposure to new or existing sources of contaminants. (See Part 1.D.2.q., E.1. d. f. g. and h.)  
*If "Yes", answer questions a - m. If "No", go to Section 17.*

NO       YES

	Relevant Part I Question(s)	No, or small impact may occur	Moderate to large impact may occur
a. The proposed action is located within 1500 feet of a school, hospital, licensed day care center, group home, nursing home or retirement community.	E1d	<input type="checkbox"/>	<input type="checkbox"/>
b. The site of the proposed action is currently undergoing remediation.	E1g, E1h	<input type="checkbox"/>	<input type="checkbox"/>
c. There is a completed emergency spill remediation, or a completed environmental site remediation on, or adjacent to, the site of the proposed action.	E1g, E1h	<input type="checkbox"/>	<input type="checkbox"/>
d. The site of the action is subject to an institutional control limiting the use of the property (e.g., easement or deed restriction).	E1g, E1h	<input type="checkbox"/>	<input type="checkbox"/>
e. The proposed action may affect institutional control measures that were put in place to ensure that the site remains protective of the environment and human health.	E1g, E1h	<input type="checkbox"/>	<input type="checkbox"/>
f. The proposed action has adequate control measures in place to ensure that future generation, treatment and/or disposal of hazardous wastes will be protective of the environment and human health.	D2t	<input type="checkbox"/>	<input type="checkbox"/>
g. The proposed action involves construction or modification of a solid waste management facility.	D2q, E1f	<input type="checkbox"/>	<input type="checkbox"/>
h. The proposed action may result in the unearthing of solid or hazardous waste.	D2q, E1f	<input type="checkbox"/>	<input type="checkbox"/>
i. The proposed action may result in an increase in the rate of disposal, or processing, of solid waste.	D2r, D2s	<input type="checkbox"/>	<input type="checkbox"/>
j. The proposed action may result in excavation or other disturbance within 2000 feet of a site used for the disposal of solid or hazardous waste.	E1f, E1g E1h	<input type="checkbox"/>	<input type="checkbox"/>
k. The proposed action may result in the migration of explosive gases from a landfill site to adjacent off site structures.	E1f, E1g	<input type="checkbox"/>	<input type="checkbox"/>
l. The proposed action may result in the release of contaminated leachate from the project site.	D2s, E1f, D2r	<input type="checkbox"/>	<input type="checkbox"/>
m. Other impacts: _____			

**17. Consistency with Community Plans**

The proposed action is not consistent with adopted land use plans.  
(See Part 1. C.1, C.2, and C.3.)

NO

YES

*If "Yes", answer questions a - h. If "No", go to Section 18.*

	Relevant Part I Question(s)	No, or small impact may occur	Moderate to large impact may occur
a. The proposed action's land use components may be different from, or in sharp contrast to, current surrounding land use pattern(s).	C2, C3, D1a E1a, E1b	<input type="checkbox"/>	<input type="checkbox"/>
b. The proposed action will cause the permanent population of the city, town or village in which the project is located to grow by more than 5%.	C2	<input type="checkbox"/>	<input type="checkbox"/>
c. The proposed action is inconsistent with local land use plans or zoning regulations.	C2, C2, C3	<input type="checkbox"/>	<input type="checkbox"/>
d. The proposed action is inconsistent with any County plans, or other regional land use plans.	C2, C2	<input type="checkbox"/>	<input type="checkbox"/>
e. The proposed action may cause a change in the density of development that is not supported by existing infrastructure or is distant from existing infrastructure.	C3, D1c, D1d, D1f, D1d, E1b	<input type="checkbox"/>	<input type="checkbox"/>
f. The proposed action is located in an area characterized by low density development that will require new or expanded public infrastructure.	C4, D2c, D2d D2j	<input type="checkbox"/>	<input type="checkbox"/>
g. The proposed action may induce secondary development impacts (e.g., residential or commercial development not included in the proposed action)	C2a	<input type="checkbox"/>	<input type="checkbox"/>
h. Other: _____ _____		<input type="checkbox"/>	<input type="checkbox"/>

**18. Consistency with Community Character**

The proposed project is inconsistent with the existing community character.  
(See Part 1. C.2, C.3, D.2, E.3)

NO

YES

*If "Yes", answer questions a - g. If "No", proceed to Part 3.*

	Relevant Part I Question(s)	No, or small impact may occur	Moderate to large impact may occur
a. The proposed action may replace or eliminate existing facilities, structures, or areas of historic importance to the community.	E3e, E3f, E3g	<input type="checkbox"/>	<input type="checkbox"/>
b. The proposed action may create a demand for additional community services (e.g. schools, police and fire)	C4	<input type="checkbox"/>	<input type="checkbox"/>
c. The proposed action may displace affordable or low-income housing in an area where there is a shortage of such housing.	C2, C3, D1f D1g, E1a	<input type="checkbox"/>	<input type="checkbox"/>
d. The proposed action may interfere with the use or enjoyment of officially recognized or designated public resources.	C2, E3	<input type="checkbox"/>	<input type="checkbox"/>
e. The proposed action is inconsistent with the predominant architectural scale and character.	C2, C3	<input type="checkbox"/>	<input type="checkbox"/>
f. Proposed action is inconsistent with the character of the existing natural landscape.	C2, C3 E1a, E1b E2g, E2h	<input type="checkbox"/>	<input type="checkbox"/>
g. Other impacts: _____ _____		<input type="checkbox"/>	<input type="checkbox"/>

Project : Date : 

***Full Environmental Assessment Form***  
***Part 3 - Evaluation of the Magnitude and Importance of Project Impacts***  
***and***  
***Determination of Significance***

Part 3 provides the reasons in support of the determination of significance. The lead agency must complete Part 3 for every question in Part 2 where the impact has been identified as potentially moderate to large or where there is a need to explain why a particular element of the proposed action will not, or may, result in a significant adverse environmental impact.

Based on the analysis in Part 3, the lead agency must decide whether to require an environmental impact statement to further assess the proposed action or whether available information is sufficient for the lead agency to conclude that the proposed action will not have a significant adverse environmental impact. By completing the certification on the next page, the lead agency can complete its determination of significance.

**Reasons Supporting This Determination:**

To complete this section:

- Identify the impact based on the Part 2 responses and describe its magnitude. Magnitude considers factors such as severity, size or extent of an impact.
- Assess the importance of the impact. Importance relates to the geographic scope, duration, probability of the impact occurring, number of people affected by the impact and any additional environmental consequences if the impact were to occur.
- The assessment should take into consideration any design element or project changes.
- Repeat this process for each Part 2 question where the impact has been identified as potentially moderate to large or where there is a need to explain why a particular element of the proposed action will not, or may, result in a significant adverse environmental impact.
- Provide the reason(s) why the impact may, or will not, result in a significant adverse environmental impact
- For Conditional Negative Declarations identify the specific condition(s) imposed that will modify the proposed action so that no significant adverse environmental impacts will result.
- Attach additional sheets, as needed.

**Determination of Significance - Type 1 and Unlisted Actions**

SEQR Status:  Type 1  Unlisted

Identify portions of EAF completed for this Project:  Part 1  Part 2  Part 3



Upon review of the information recorded on this EAF, as noted, plus this additional support information

and considering both the magnitude and importance of each identified potential impact, it is the conclusion of the \_\_\_\_\_ as lead agency that:

A. This project will result in no significant adverse impacts on the environment, and, therefore, an environmental impact statement need not be prepared. Accordingly, this negative declaration is issued.

B. Although this project could have a significant adverse impact on the environment, that impact will be avoided or substantially mitigated because of the following conditions which will be required by the lead agency:

There will, therefore, be no significant adverse impacts from the project as conditioned, and, therefore, this conditioned negative declaration is issued. A conditioned negative declaration may be used only for UNLISTED actions (see 6 NYCRR 617.d).

C. This Project may result in one or more significant adverse impacts on the environment, and an environmental impact statement must be prepared to further assess the impact(s) and possible mitigation and to explore alternatives to avoid or reduce those impacts. Accordingly, this positive declaration is issued.

Name of Action:

Name of Lead Agency:

Name of Responsible Officer in Lead Agency:

Title of Responsible Officer:

Signature of Responsible Officer in Lead Agency:

Date:

Signature of Preparer (if different from Responsible Officer)

Date:

**For Further Information:**

Contact Person:

Address:

Telephone Number:

E-mail:

**For Type 1 Actions and Conditioned Negative Declarations, a copy of this Notice is sent to:**

Chief Executive Officer of the political subdivision in which the action will be principally located (e.g., Town / City / Village of)

Other involved agencies (if any)

Applicant (if any)

Environmental Notice Bulletin: <http://www.dec.ny.gov/enb/enb.html>

**PRINT FULL FORM**

## SEQR RESOLUTION

**WHEREAS**, the St. Lawrence-Lewis Board of Cooperative Educational Services (the “BOCES”) seeks to undertake a district wide capital improvement project, including, but not limited to:

Renovations, upgrades and improvements to existing finishes, plumbing, HVAC and electrical systems, security improvements and handicap access, building additions, sitework including drainage improvements, sidewalk replacement, paving and new exterior signage and demolition of structures at the Northwest Technical Center, Southwest Technical Center and Seaway Area Technical Center.

**WHEREAS**, the State Environmental Quality Review Act (“SEQRA”) and the regulations thereunder require the Board to undertake a review of the potential environmental impacts, if any, associated with the project before approving same; and

**WHEREAS**, this project is a Type 1 Action within the meaning of SEQRA; and

**WHEREAS**, on June 20, 2018, a notice was transmitted to all involved agencies of the Board’s desire to act as lead agency with respect to the environmental review of the proposed Project; and

**WHEREAS**, no agency has objected to the designation of the BOCES as lead agency with respect to the environmental review of the proposed Project; and

**WHEREAS**, 6 NYCRR Section 617.7 requires a lead agency to issue a written determination of significance with respect to any proposed Type 1 action;

**WHEREAS**, the BOCES has carefully considered the nature and scope of the proposed Project, as set forth in the Full Environmental Assessment Form prepared with respect to such action, and makes the following determinations:

1. The proposed action involves:

Renovations, upgrades and improvements to existing finishes, plumbing, HVAC and electrical systems, security improvements and handicap access, building additions, sitework

including drainage improvements, sidewalk replacement, paving and new exterior signage and demolition of structures at the Northwest Technical Center, Southwest Technical Center and Seaway Area Technical Center.

2. The proposed action is classified under SEQRA as a Type 1 action within the meaning of 6 NYCRR §617.4.

3. Upon consideration of the action, review of the Environmental Assessment Form, the criteria contained in 6 NYCRR §617.4, and all other supporting information, the BOCES identifies the following relevant areas of environmental concern, as set forth hereafter, and analyzes whether the proposed action may have a significant adverse impact on the environment.

4. The development and use of the property will result in a small to moderate impact on land during the period of construction since construction may continue for more than one year or involve more than one stage. Any impact will be mitigated during the construction process.

5. The proposed development and use of the property will not adversely impact geological features.

6. The proposed development and use of the property will not adversely impact surface water.

7. The proposed development and use of the property will have a small to moderate impact upon ground water which shall be mitigated during construction in compliance with applicable permits.

8. The proposed development and use of the property will not adversely result in flooding.

9. The proposed development and use of the property will not adversely impact air.

10. The proposed development and use of the property will not adversely impact plants and animals.

11. The proposed development and use of the property will not adversely impact agricultural resources.

12. The proposed development and use of the property will not adversely impact aesthetic resources.

13. The proposed development and use of the property will not adversely impact historic or archeological resources.

14. The proposed development and use of the property will not adversely impact open space and recreation areas.

15. The proposed development and use of the property will not adversely impact critical environmental areas.

16. The proposed development and use of the property will not adversely impact transportation systems.

17. The proposed development and use of the property will have a small to moderate impact upon energy.

18. The proposed development and use of the property will have a small to moderate impact upon noise, odor and light.

19. The proposed development and use of the property will not adversely impact human health.

20. The proposed development and use of the property is consistent with community plans.

21. The proposed development and use of the property is consistent with community character.

**NOW, THEREFORE, BE IT RESOLVED,** that the BOCES finds and concludes that

the proposed action is a Type 1 Action within the meaning of 6 NYCRR 617.4; and it is further

**RESOLVED** that the BOCES hereby declares itself lead agency with respect to the environmental review of the proposed project; and it is further

**RESOLVED**, that upon consideration of the foregoing, the BOCES finds and concludes that the proposed action will not result in any significant adverse impacts to the environment; and it is further

**RESOLVED**, that the BOCES hereby issues a Negative Declaration with respect to the proposed action; and it is further

**RESOLVED**, that the BOCES hereby authorizes and directs the District Superintendent or his designee to file this Negative Declaration with the appropriate parties and agencies.

The vote on the foregoing Resolution was as follows:

Name:

Roger Bennett	<i>Roger Bennett</i>	Yes
Dana Smith	<i>Dana Smith</i>	yes
William Cartwright	<i>William Cartwright</i>	yes
Michael Davis	<i>Michael J. Davis</i>	Yes
James Lattimer	<i>James K. Lattimer</i>	yes
Marjorie McCullough	<i>Marjorie McCullough</i>	yes
James Young	<i>James Young</i>	yes
John Zeh	<i>John Zeh</i>	yes

State Environmental Quality Review  
**NEGATIVE DECLARATION**  
Notice of Determination of Non-Significance

Project Number

Date: 7/ /2018

This notice is issued pursuant to Part 617 of the implementing regulations pertaining to Article 8 (State Environmental Quality Review Act) of the Environmental Conservation Law.

The St. Lawrence-Lewis Board of Cooperative Educational Servicest, as lead agency, has determined that the proposed action described below will not have a significant environmental impact and a Draft Environmental Impact Statement will not be prepared.

**Name of Action:** St. Lawrence-Lewis BOCES – Capital Project

**SEQR Status:** Type 1 X  
Unlisted

**Conditioned Negative Declaration:**  Yes

No

**Description of Action:**

Renovations, upgrades and improvements to existing finishes, plumbing, HVAC and electrical systems, security improvements and handicap access, building additions, sitework including drainage improvements, sidewalk replacement, paving and new exterior signage and demolition of structures at the Northwest Technical Center, Southwest Technical Center and Seaway Area Technical Center.

**Location:** (Include street address and the name of the municipality/county. A location map of appropriate scale is also recommended.)

Northwest Technical Center  
100 Park Street  
Ogdensburg, NY 13669

Southwest Technical Center  
3606 State Highway 58  
Gouverneur, NY 13642

Seaway Area Technical Center  
7227 State Highway 56  
Norwood, NY 13668

**Reasons Supporting This Determination:**

(See 617.7(a)-(c) for requirements of this determination; see 617.7(d) for Conditioned Negative Declaration)

Upon review and consideration of the project environmental assessment form, Part I and II as well as review and consideration of the comments, if any, from the various involved and interested agencies, the Board of Education, as lead agency, following a thorough review and consideration of the conditions set forth in 6 N.Y.C.R.R. §617.7 has determined that the project will not result in a large or significant adverse impact on the environment.

**If Conditioned Negative Declaration**, provide on attachment the specific mitigation measures imposed, and identify comment period (not less than 30 days from the date of publication in the ENB)

**For Further Information:**

Contact Person: Thomas Burns, District Superintendent

Address: St. Lawrence-Lewis Board of Cooperative Educational Services  
40 West Street  
Canton, NY 13617

Telephone Number: (315) 386-4504

**For Type 1 Actions and Conditioned Negative Declarations, a Copy of this Notice is sent to:**

New York State Education Department, New York State Department of Environmental Conservation,  
St. Lawrence County Health Department

Other involved agencies (If any)

Applicant (If any)



**DASNY**

## SMART GROWTH IMPACT STATEMENT ASSESSMENT FORM

**Date:** April 3, 2020

**Project Number:**358510

**Project Applicant:** St. Lawrence-Lewis Board of Cooperative Educational Services  
**Project Name:** *Renovations, Upgrades and Expansion at the Northwest, Southwest, and Seaway Area Technical Centers*

**Program:** Board of Cooperative Educational Services (BOCES) Program

**Project Location:** Northwest Technical Center (“NWTC”), 1000 Park Street, Ogdensburg, Southwest Technical Center (“SWTC”), 3606 State Highway 58, Gouverneur, and Seaway Area Technical Center (“SATC”) 7227 State Highway 56, Norwood. All are located within St. Lawrence County

**Completed by:** Robert S. Derico, R.A., Director, Office of Environmental Affairs

This Smart Growth Impact Statement Assessment Form (“SGISAF”) is a tool to assist the applicant and the Dormitory Authority of the State of New York’s (“DASNY’s”) Smart Growth Advisory Committee in deliberations to determine whether a project is consistent with the New York State *Smart Growth Public Infrastructure Policy Act (“SSGPIPA”)*, Article 6 of the New York State *Environmental Conservation Law (“ECL”)*.<sup>1</sup> Not all questions/answers may be relevant or applicable to all projects.

**Description of Proposed Action and Proposed Project:** The proposed bond issuance would finance these common components at all three Technical Centers: The upgrade and renovation of existing space to include improvements to the existing finishes, plumbing, HVAC, and electrical systems. In addition, the proposed work would also include security improvements, including card access and controlled entrances, video surveillance and door and window hardening. Handicapped accessibility and Americans with Disabilities Act (“ADA”) improvements would also be included at the three facilities. Interior space modification or adjustments to meet educational program needs may also be contemplated. Specific projects components to be financed at the individual technical center includes:

At NWTC: Construction of an approximately 7,000-square-foot addition to develop program space and new mechanical-electrical space and sitework to include drainage improvements, sidewalk replacement, paving and new exterior signage. The area of site disturbance is expected to be less than 1-acre in area.

At SWTC: Construction of an approximately 5,000-square-foot addition to develop program space and new mechanical-electrical space and sitework to include drainage improvements, sidewalk replacement, paving and new exterior signage. The area of site disturbance is expected to be less than 1-acre in area.

At SATC: Construction of an approximately 18,000-square-foot addition to develop new classrooms laboratory spaces, and necessary support spaces. Several existing buildings would also be demolished. Sitework would include possible connection to the existing municipal water system, drainage improvements, sidewalk replacement, paving and new exterior signage. The area of site disturbance is expected to be approximately 1 acre in area.

**Smart Growth Impact Assessment:** Have any other entities issued a Smart Growth Impact Statement (“SGIS”) with regard to this project? (If so, attach same).  Yes  No

1. Does the project advance or otherwise involve the use of, maintain, or improve existing infrastructure?  
Check one and describe:  Yes  No  Not Relevant

<sup>1</sup> <https://www.nysenate.gov/legislation/laws/ENV/A6>



2. Is the project located wholly or partially in a **municipal center**,<sup>2</sup> characterized by any of the following: Check all that apply and explain briefly:
- A city or a village
  - Within the boundaries of a generally-recognized college, university, hospital or nursing-home campus
  - Area of concentrated and mixed land use that serves as a center for various activities including, but not limited to: **see below**
    - Central business districts (i.e., commercial or geographic heart of a city, downtown or "city center")
    - Main streets (i.e., primary retail street of a village, town, or small city)
    - Downtown areas (i.e., city's core, center or central business district)
    - Brownfield opportunity areas (<https://www.dos.ny.gov/opd/programs/brownFieldOpp/index.html>)
    - Downtown areas of Local Waterfront Revitalization Programs ("LWRPs") (<https://www.dos.ny.gov/opd/programs/lwrp.html>)
    - Transit-oriented development areas (i.e., areas with access to public transit for residents)
    - Environmental justice areas (<https://www.dec.ny.gov/public/911.html>)
    - Hardship areas
3. Is the project located adjacent to municipal centers (please see characteristics in question 2, above) with clearly-defined borders, in an area designated for concentrated development in the future by a municipal or regional comprehensive plan that exhibits strong land use, transportation, infrastructure and economic connections to an existing municipal center? Check one and describe:  Yes  No  Not Relevant
4. Is the project located in an area designated by a municipal or comprehensive plan, and appropriately zoned, as a future municipal center? Check one and describe:  Yes  No  Not Relevant
5. Is the project located wholly or partially in a developed area or an area designated for concentrated infill development in accordance with a municipally-approved comprehensive land use plan, a local waterfront revitalization plan, brownfield opportunity area plan or other development plan? Check one and describe:  Yes  No  Not Relevant
6. Does the project preserve and enhance the state's resources, including agricultural lands, forests, surface and groundwater, air quality, recreation and open space, scenic areas, and/or significant historic and archeological resources? Check one and describe:  Yes  No  Not Relevant
7. Does the project foster mixed land uses and compact development, downtown revitalization, brownfield redevelopment, the enhancement of beauty in public spaces, the diversity and affordability of housing in proximity to places of employment, recreation and commercial development and/or the integration of all income and age groups? Check one and describe:  Yes  No  Not Relevant
8. Does the project provide mobility through transportation choices, including improved public transportation and reduced automobile dependency? Check one and describe:  Yes  No  Not Relevant
9. Does the project demonstrate coordination among state, regional, and local planning and governmental officials?<sup>3</sup> Check one and describe:  Yes  No  Not Relevant
10. Does the project involve community-based planning and collaboration? Check one and describe:  Yes  No  Not Relevant
11. Is the project consistent with local building and land use codes? Check one and describe:  Yes  No  Not Relevant

<sup>2</sup> DASNY interprets the term "municipal centers" to include existing, developed institutional campuses such as universities, colleges and hospitals.

<sup>3</sup> Demonstration may include *State Environmental Quality Review* ["SEQR"] coordination with involved and interested agencies, district formation, agreements between involved parties, letters of support, State Pollutant Discharge Elimination System ["SPDES"] permit issuance/revision notices, etc.

12. Does the project promote sustainability by strengthening existing and creating new communities which reduce greenhouse gas emissions and do not compromise the needs of future generations? Check one and describe:  Yes  No  Not Relevant
13. During the development of the project, was there broad-based public involvement?<sup>4</sup> Check one and describe:  Yes  No  Not Relevant
14. Does the Recipient have an ongoing governance structure to sustain the implementation of community planning? Check one and describe:  Yes  No  Not Relevant
15. Does the project mitigate future physical climate risk due to sea level rise, and/or storm surges and/or flooding, based on available data predicting the likelihood of future extreme weather events, including hazard risk analysis data if applicable? Check one and describe:  Yes  No  Not Relevant

**DASNY has reviewed the available information regarding this project and finds:**

- The project was developed in general consistency with the relevant Smart Growth Criteria.  
 The project was not developed in general consistency with the relevant Smart Growth Criteria.  
 It was impracticable to develop this project in a manner consistent with the relevant Smart Growth Criteria for the following reasons: \_\_\_\_\_

**ATTESTATION**

I, President of DASNY/designee of the President of DASNY, hereby attest that the Proposed Project, to the extent practicable, meets the relevant criteria set forth above and that to the extent that it is not practical to meet any relevant criterion, for the reasons given above.



DATE: April 3, 2020

**Signature/Date**

Robert S. Derico, R.A., Director, Office of Environmental Affairs

**Print Name and Title**

<sup>4</sup> Documentation may include *SEQR* coordination with involved and interested agencies, SPDES permit issuance/revision notice, approval of Bond Resolution, formation of district, evidence of public hearings, *Environmental Notice Bulletin* ["ENB"] or other published notices, letters of support, etc.

Review No. 19-0577



**Parks, Recreation,  
and Historic Preservation**

**ANDREW M. CUOMO**  
Governor

**ERIK KULLESEID**  
Commissioner

October 07, 2019

Mrs. Donna Lahey  
Construction Administrator  
MARCH Associates  
258 Genesee Street  
Suite 300  
Utica, NY 13502

Re: SED  
Seaway Area Technical Center - Hazardous Material Removal, Building Additions & Alterations Project  
7225 State Highway 56, Potsdam, St. Lawrence County, NY  
19PR06831  
SED #51-90-00-00-0-012-011

Dear Mrs. Lahey:

Thank you for requesting the comments of the Office of Parks, Recreation and Historic Preservation (OPRHP). We have reviewed the project in accordance with the New York State Historic Preservation Act of 1980 (Section 14.09 of the New York Parks, Recreation and Historic Preservation Law). These comments are those of the OPRHP and relate only to Historic/Cultural resources. They do not include potential environmental impacts to New York State Parkland that may be involved in or near your project. Such impacts must be considered as part of the environmental review of the project pursuant to the State Environmental Quality Review Act (New York Environmental Conservation Law Article 8) and its implementing regulations (6 NYCRR Part 617).

Based upon this review, it is the opinion of OPRHP that no properties, including archaeological and/or historic resources, listed in or eligible for the New York State and National Registers of Historic Places will be impacted by this project.

If further correspondence is required regarding this project, please be sure to refer to the OPRHP Project Review (PR) number noted above.

Sincerely,

R. Daniel Mackay  
Deputy Commissioner for Historic Preservation  
Division for Historic Preservation

---

**Division for Historic Preservation**



**THE STATE EDUCATION DEPARTMENT / THE UNIVERSITY OF THE STATE OF NEW YORK**

Office of Facilities Planning, 89 Washington Avenue, Room 1060 Education Building Annex, Albany, NY 12234  
Tel. (518) 474-3906  
Email: emscfp@nysed.gov  
www.p12.nysed.gov/facplan/

**NYS Office of Parks, Recreation, and Historic Preservation  
Project Review Exemption Based on the  
Letter of Resolution**

District:	St. Lawrence-Lewis BOCES	Date:	09/26/19
Building:	Seaway Area Technical Center	Firm:	MARCH Associates
Building Address:	7225 State Highway 56, Norwood, NY 13668	Firm Address:	258 Genesee Street, Suite 300 Utica, NY 13502

SED Project Control Number 5 1 9 0 0 0 0 0 0 0 1 2 0 1 1

In Accordance with the Letter of Resolution (LOR) between the New York State Education Department (SED), and the New York State Office of Parks, Recreation, and Historic Preservation (OPRHP), this project is **exempt** from OPRHP review based on the following:

The Building is less than 50 years old at the time of project initiation and it is not the work of a recognized Master Architect, Designer, or Builder, or associated with persons or events significant in the history of the State of New York.

The undersigned licensed professional hereby certifies that regardless of the above selection, any portions of the project that include site work or ground disturbance, not in compliance with Appendix A, have been submitted to OPRHP for review of possible impacts to archeological resources. If submitted for OPRHP review, attach a copy of the transmittal letter or the SHPO determination letter.

This Building is 50 years old or older. The entire building has been previously evaluated by OPRHP and found not to meet the criteria for inclusion in the State and National Register. (**NOTE: Attach previous determination from OPRHP stating the entire building does not meet criteria.**)

The undersigned licensed professional hereby certifies that regardless of the above selection, any portions of the project that include site work or ground disturbance, not in compliance with Appendix A, have been submitted to OPRHP for review of possible impacts to archeological resources. If submitted for OPRHP review, attach a copy of the transmittal letter or the SHPO determination letter.

The project work on this building falls under Appendix A of the LOR, has been designed in accordance with the LOR, certain scope of work items have been submitted to OPRHP for review and approval if required by the LOR, and therefore the project will have little or no potential impact on the character of historic resources. (**NOTE: Attach copy of transmittal submitting portions of work to OPRHP if required.**)

The undersigned licensed professional hereby certifies that regardless of the above selection, any portions of the project that include site work or ground disturbance, not in compliance with Appendix A, have been submitted to OPRHP for review of possible impacts to archeological resources. If submitted for OPRHP review, attach a copy of the transmittal letter or the SHPO determination letter.

**CERTIFICATION:**

The undersigned licensed professional hereby certifies that the work of this project is exempt from OPRHP review for historic resources based on the above selections.

  
\_\_\_\_\_  
Signature  
Christopher J. Crolius, AIA, Principal  
\_\_\_\_\_  
Print Name

022954  
\_\_\_\_\_  
License Number



**THE STATE EDUCATION DEPARTMENT / THE UNIVERSITY OF THE STATE OF NEW YORK**

Office of Facilities Planning, 89 Washington Avenue, Room 1060 Education Building Annex, Albany, NY 12234  
Tel. (518) 474-3906  
Email: emscfp@nysed.gov  
www.p12.nysed.gov/facplan/

**NYS Office of Parks, Recreation, and Historic Preservation  
Project Review Exemption Based on the  
Letter of Resolution**

District:	<u>St. Lawrence-Lewis BOCES</u>	Date:	<u>09/26/19</u>
Building:	<u>Southwest Technical Center</u>	Firm:	<u>MARCH Associates</u>
Building Address:	<u>3606 State Highway 58, Gouverneur, NY 13642</u>	Firm Address:	<u>258 Genesee Street, Suite 300 Utica, NY 13502</u>

SED Project Control Number 

5	1	9	0	0	0	0	0	0	0	1	3	0	1	1
---	---	---	---	---	---	---	---	---	---	---	---	---	---	---

In Accordance with the Letter of Resolution (LOR) between the New York State Education Department (SED), and the New York State Office of Parks, Recreation, and Historic Preservation (OPRHP), this project is **exempt** from OPRHP review based on the following:

The Building is less than 50 years old at the time of project initiation and it is not the work of a recognized Master Architect, Designer, or Builder, or associated with persons or events significant in the history of the State of New York.

The undersigned licensed professional hereby certifies that regardless of the above selection, any portions of the project that include site work or ground disturbance, not in compliance with Appendix A, have been submitted to OPRHP for review of possible impacts to archeological resources. If submitted for OPRHP review, attach a copy of the transmittal letter or the SHPO determination letter.

This Building is 50 years old or older. The entire building has been previously evaluated by OPRHP and found not to meet the criteria for inclusion in the State and National Register. (**NOTE: Attach previous determination from OPRHP stating the entire building does not meet criteria.**)

The undersigned licensed professional hereby certifies that regardless of the above selection, any portions of the project that include site work or ground disturbance, not in compliance with Appendix A, have been submitted to OPRHP for review of possible impacts to archeological resources. If submitted for OPRHP review, attach a copy of the transmittal letter or the SHPO determination letter.

The project work on this building falls under Appendix A of the LOR, has been designed in accordance with the LOR, certain scope of work items have been submitted to OPRHP for review and approval if required by the LOR, and therefore the project will have little or no potential impact on the character of historic resources. (**NOTE: Attach copy of transmittal submitting portions of work to OPRHP if required.**)

The undersigned licensed professional hereby certifies that regardless of the above selection, any portions of the project that include site work or ground disturbance, not in compliance with Appendix A, have been submitted to OPRHP for review of possible impacts to archeological resources. If submitted for OPRHP review, attach a copy of the transmittal letter or the SHPO determination letter.

**CERTIFICATION:**

The undersigned licensed professional hereby certifies that the work of this project is exempt from OPRHP review for historic resources based on the above selections.

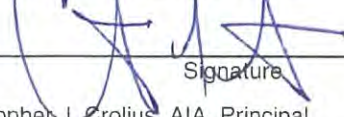
  
\_\_\_\_\_  
Signature  
Christopher J. Crolius, AIA, Principal  
\_\_\_\_\_  
Print Name

022954  
\_\_\_\_\_  
License Number

Review # 19-0579



**Parks, Recreation,  
and Historic Preservation**

ANDREW M. CUOMO  
Governor

ERIK KULLESEID  
Commissioner

October 03, 2019

Mrs. Donna Lahey  
Construction Administrator  
MARCH Associates  
258 Genesee Street  
Suite 300  
Utica, NY 13502

Re: SED  
Northwest Technical Center - Addition & Alterations  
1000 Park Street, Ogdensburg, St. Lawrence County, NY  
19PR06822  
SED #51-90-00-00-0-014-008

Dear Mrs. Lahey:

Thank you for requesting the comments of the Office of Parks, Recreation and Historic Preservation (OPRHP). We have reviewed the project in accordance with the New York State Historic Preservation Act of 1980 (Section 14.09 of the New York Parks, Recreation and Historic Preservation Law). These comments are those of the OPRHP and relate only to Historic/Cultural resources. They do not include potential environmental impacts to New York State Parkland that may be involved in or near your project. Such impacts must be considered as part of the environmental review of the project pursuant to the State Environmental Quality Review Act (New York Environmental Conservation Law Article 8) and its implementing regulations (6 NYCRR Part 617).

Based upon this review, it is the opinion of OPRHP that no properties, including archaeological and/or historic resources, listed in or eligible for the New York State and National Registers of Historic Places will be impacted by this project.

If further correspondence is required regarding this project, please be sure to refer to the OPRHP Project Review (PR) number noted above.

Sincerely,

R. Daniel Mackay

Deputy Commissioner for Historic Preservation  
Division for Historic Preservation



**THE STATE EDUCATION DEPARTMENT / THE UNIVERSITY OF THE STATE OF NEW YORK**

Office of Facilities Planning, 89 Washington Avenue, Room 1060 Education Building Annex, Albany, NY 12234  
Tel. (518) 474-3906  
Email: emscfp@nysed.gov  
www.p12.nysed.gov/facplan/

**NYS Office of Parks, Recreation, and Historic Preservation  
Project Review Exemption Based on the  
Letter of Resolution**

District:	<u>St. Lawrence-Lewis BOCES</u>	Date:	<u>09/26/19</u>
Building:	<u>Northwest Technical Center</u>	Firm:	<u>MARCH Associates</u>
Building Address:	<u>1000 Park Street, Ogdensburg, NY 13669</u>	Firm Address:	<u>258 Genesee Street, Suite 300 Utica, NY 13502</u>

SED Project Control Number 

5	1	9	0	0	0	0	0	0	0	1	4	0	0	8
---	---	---	---	---	---	---	---	---	---	---	---	---	---	---

In Accordance with the Letter of Resolution (LOR) between the New York State Education Department (SED), and the New York State Office of Parks, Recreation, and Historic Preservation (OPRHP), this project is **exempt** from OPRHP review based on the following:

The Building is less than 50 years old at the time of project initiation and it is not the work of a recognized Master Architect, Designer, or Builder, or associated with persons or events significant in the history of the State of New York.

The undersigned licensed professional hereby certifies that regardless of the above selection, any portions of the project that include site work or ground disturbance, not in compliance with Appendix A, have been submitted to OPRHP for review of possible impacts to archeological resources. If submitted for OHRHP review, attach a copy of the transmittal letter or the SHPO determination letter.

This Building is 50 years old or older. The entire building has been previously evaluated by OPRHP and found not to meet the criteria for inclusion in the State and National Register. **(NOTE: Attach previous determination from OPRHP stating the entire building does not meet criteria.)**

The undersigned licensed professional hereby certifies that regardless of the above selection, any portions of the project that include site work or ground disturbance, not in compliance with Appendix A, have been submitted to OPRHP for review of possible impacts to archeological resources. If submitted for OHRHP review, attach a copy of the transmittal letter or the SHPO determination letter.

The project work on this building falls under Appendix A of the LOR, has been designed in accordance with the LOR, certain scope of work items have been submitted to OPRHP for review and approval if required by the LOR, and therefore the project will have little or no potential impact on the character of historic resources. **(NOTE: Attach copy of transmittal submitting portions of work to OPRHP if required.)**

The undersigned licensed professional hereby certifies that regardless of the above selection, any portions of the project that include site work or ground disturbance, not in compliance with Appendix A, have been submitted to OPRHP for review of possible impacts to archeological resources. If submitted for OHRHP review, attach a copy of the transmittal letter or the SHPO determination letter.

**CERTIFICATION:**

The undersigned licensed professional hereby certifies that the work of this project is exempt from OPRHP review for historic resources based on the above selections.

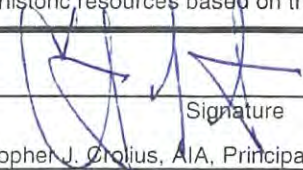
  
\_\_\_\_\_  
Signature  
Christopher J. Crolius, AIA, Principal  
\_\_\_\_\_  
Print Name

022954  
\_\_\_\_\_  
License Number

Review No. 19-0580



**Parks, Recreation,  
and Historic Preservation**

**ANDREW M. CUOMO**  
Governor

**ERIK KULLESEID**  
Commissioner

October 21, 2019

Mrs. Donna Lahey  
Construction Administrator  
MARCH Associates  
258 Genesee Street  
Suite 300  
Utica, NY 13502

Re: SED  
Northwest Technical Center Child Care Building - Demolition  
1000 Park Street, Ogdensburg, St. Lawrence County, NY  
19PR06814  
SED #51-90-00-00-0-018-004

Dear Mrs. Lahey:

Thank you for requesting the comments of the Office of Parks, Recreation and Historic Preservation (OPRHP). We have reviewed the project in accordance with the New York State Historic Preservation Act of 1980 (Section 14.09 of the New York Parks, Recreation and Historic Preservation Law). These comments are those of the OPRHP and relate only to Historic/Cultural resources. They do not include potential environmental impacts to New York State Parkland that may be involved in or near your project. Such impacts must be considered as part of the environmental review of the project pursuant to the State Environmental Quality Review Act (New York Environmental Conservation Law Article 8) and its implementing regulations (6 NYCRR Part 617).

Based upon this review, it is the opinion of OPRHP that no properties, including archaeological and/or historic resources, listed in or eligible for the New York State and National Registers of Historic Places will be impacted by this project.

If further correspondence is required regarding this project, please be sure to refer to the OPRHP Project Review (PR) number noted above.

Sincerely,

R. Daniel Mackay  
Deputy Commissioner for Historic Preservation  
Division for Historic Preservation





**THE STATE EDUCATION DEPARTMENT / THE UNIVERSITY OF THE STATE OF NEW YORK**

Office of Facilities Planning, 89 Washington Avenue, Room 1060 Education Building Annex, Albany, NY 12234  
Tel. (518) 474-3906  
Email: emscfp@nysed.gov  
www.p12.nysed.gov/facplan/

**NYS Office of Parks, Recreation, and Historic Preservation  
Project Review Exemption Based on the  
Letter of Resolution**

District:	St. Lawrence-Lewis BOCES	Date:	09/26/19
Building:	Northwest Tech Child Care Building	Firm:	MARCH Associates
Building Address:	1000 Park Street, Ogdensburg, NY 13669	Firm Address:	258 Genesee Street, Suite 300 Utica, NY 13502

SED Project Control Number: 5 1 9 0 0 0 0 0 0 0 1 8 0 0 4

In Accordance with the Letter of Resolution (LOR) between the New York State Education Department (SED), and the New York State Office of Parks, Recreation, and Historic Preservation (OPRHP), this project is **exempt** from OPRHP review based on the following:

The Building is less than 50 years old at the time of project initiation and it is not the work of a recognized Master Architect, Designer, or Builder, or associated with persons or events significant in the history of the State of New York.

The undersigned licensed professional hereby certifies that regardless of the above selection, any portions of the project that include site work or ground disturbance, not in compliance with Appendix A, have been submitted to OPRHP for review of possible impacts to archeological resources. If submitted for OPRHP review, attach a copy of the transmittal letter or the SHPO determination letter.

This Building is 50 years old or older. The entire building has been previously evaluated by OPRHP and found not to meet the criteria for inclusion in the State and National Register. (**NOTE: Attach previous determination from OPRHP stating the entire building does not meet criteria.**)

The undersigned licensed professional hereby certifies that regardless of the above selection, any portions of the project that include site work or ground disturbance, not in compliance with Appendix A, have been submitted to OPRHP for review of possible impacts to archeological resources. If submitted for OPRHP review, attach a copy of the transmittal letter or the SHPO determination letter.

The project work on this building falls under Appendix A of the LOR, has been designed in accordance with the LOR, certain scope of work items have been submitted to OPRHP for review and approval if required by the LOR, and therefore the project will have little or no potential impact on the character of historic resources. (**NOTE: Attach copy of transmittal submitting portions of work to OPRHP if required.**)

The undersigned licensed professional hereby certifies that regardless of the above selection, any portions of the project that include site work or ground disturbance, not in compliance with Appendix A, have been submitted to OPRHP for review of possible impacts to archeological resources. If submitted for OPRHP review, attach a copy of the transmittal letter or the SHPO determination letter.

**CERTIFICATION:**

The undersigned licensed professional hereby certifies that the work of this project is exempt from OPRHP review for historic resources based on the above selections.

  
\_\_\_\_\_  
Signature  
Christopher J. Crolius, AIA, Principal  
\_\_\_\_\_  
Print Name

022954  
\_\_\_\_\_  
License Number



**Parks, Recreation,  
and Historic Preservation**

**ANDREW M. CUOMO**  
Governor

**ERIK KULLESEID**  
Commissioner

Review No. 19-0581

October 07, 2019

Mrs. Donna Lahey  
Construction Administrator  
MARCH Associates  
258 Genesee Street  
Suite 300  
Utica, NY 13502

Re: SED  
Seaway Tech Adult Education Building - Demolition  
7225 State Highway 56, Potsdam, St. Lawrence County, NY  
19PR06834  
SED #51-90-00-00-0-019-004

Dear Mrs. Lahey:

Thank you for requesting the comments of the Office of Parks, Recreation and Historic Preservation (OPRHP). We have reviewed the project in accordance with the New York State Historic Preservation Act of 1980 (Section 14.09 of the New York Parks, Recreation and Historic Preservation Law). These comments are those of the OPRHP and relate only to Historic/Cultural resources. They do not include potential environmental impacts to New York State Parkland that may be involved in or near your project. Such impacts must be considered as part of the environmental review of the project pursuant to the State Environmental Quality Review Act (New York Environmental Conservation Law Article 8) and its implementing regulations (6 NYCRR Part 617).

Based upon this review, it is the opinion of OPRHP that no properties, including archaeological and/or historic resources, listed in or eligible for the New York State and National Registers of Historic Places will be impacted by this project.

If further correspondence is required regarding this project, please be sure to refer to the OPRHP Project Review (PR) number noted above.

Sincerely,

R. Daniel Mackay  
Deputy Commissioner for Historic Preservation  
Division for Historic Preservation



**THE STATE EDUCATION DEPARTMENT / THE UNIVERSITY OF THE STATE OF NEW YORK**

Office of Facilities Planning, 89 Washington Avenue, Room 1060 Education Building Annex, Albany, NY 12234  
 Tel. (518) 474-3906  
 Email: emscfp@nysed.gov  
 www.p12.nysed.gov/facplan/

**NYS Office of Parks, Recreation, and Historic Preservation  
 Project Review Exemption Based on the  
 Letter of Resolution**

District: St. Lawrence-Lewis BOCES Date: 09/26/19  
 Building: Seaway Tech Adult Education Building Firm: MARCH Associates  
 Building Address: 7225 State Highway 56, Norwood, NY 13668 Firm Address: 258 Genesee Street, Suite 300 Utica, NY 13502

SED Project Control Number 

5	1	9	0	0	0	0	0	0	0	1	9	0	0	4
---	---	---	---	---	---	---	---	---	---	---	---	---	---	---

In Accordance with the Letter of Resolution (LOR) between the New York State Education Department (SED), and the New York State Office of Parks, Recreation, and Historic Preservation (OPRHP), this project is **exempt** from OPRHP review based on the following:

The Building is less than 50 years old at the time of project initiation and it is not the work of a recognized Master Architect, Designer, or Builder, or associated with persons or events significant in the history of the State of New York.  
 The undersigned licensed professional hereby certifies that regardless of the above selection, any portions of the project that include site work or ground disturbance, not in compliance with Appendix A, have been submitted to OPRHP for review of possible impacts to archeological resources. If submitted for OPRHP review, attach a copy of the transmittal letter or the SHPO determination letter.

This Building is 50 years old or older. The entire building has been previously evaluated by OPRHP and found not to meet the criteria for inclusion in the State and National Register. (**NOTE: Attach previous determination from OPRHP stating the entire building does not meet criteria.**)  
 The undersigned licensed professional hereby certifies that regardless of the above selection, any portions of the project that include site work or ground disturbance, not in compliance with Appendix A, have been submitted to OPRHP for review of possible impacts to archeological resources. If submitted for OPRHP review, attach a copy of the transmittal letter or the SHPO determination letter.

The project work on this building falls under Appendix A of the LOR, has been designed in accordance with the LOR, certain scope of work items have been submitted to OPRHP for review and approval if required by the LOR, and therefore the project will have little or no potential impact on the character of historic resources. (**NOTE: Attach copy of transmittal submitting portions of work to OPRHP if required.**)  
 The undersigned licensed professional hereby certifies that regardless of the above selection, any portions of the project that include site work or ground disturbance, not in compliance with Appendix A, have been submitted to OPRHP for review of possible impacts to archeological resources. If submitted for OPRHP review, attach a copy of the transmittal letter or the SHPO determination letter.

**CERTIFICATION:**  
 The undersigned licensed professional hereby certifies that the work of this project is exempt from OPRHP review for historic resources based on the above selections.

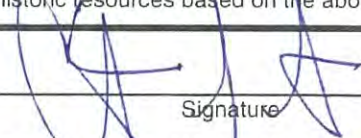
  
 \_\_\_\_\_  
 Signature  
 Christopher J. Crolius, AIA, Principal  
 \_\_\_\_\_  
 Print Name

022954  
 \_\_\_\_\_  
 License Number

Review No. 19-0582



**Parks, Recreation,  
and Historic Preservation**

ANDREW M. CUOMO  
Governor

ERIK KULLESEID  
Commissioner

October 07, 2019

Mrs. Donna Lahey  
Construction Administrator  
MARCH Associates  
258 Genesee Street  
Suite 300  
Utica, NY 13502

Re: SED  
Seaway Tech Learning Resource Center - Demolition  
7225 State Highway 56, Potsdam, St. Lawrence County, NY  
19PR06833  
SED #51-90-00-00-7-008-003

Dear Mrs. Lahey:

Thank you for requesting the comments of the Office of Parks, Recreation and Historic Preservation (OPRHP). We have reviewed the project in accordance with the New York State Historic Preservation Act of 1980 (Section 14.09 of the New York Parks, Recreation and Historic Preservation Law). These comments are those of the OPRHP and relate only to Historic/Cultural resources. They do not include potential environmental impacts to New York State Parkland that may be involved in or near your project. Such impacts must be considered as part of the environmental review of the project pursuant to the State Environmental Quality Review Act (New York Environmental Conservation Law Article 8) and its implementing regulations (6 NYCRR Part 617).

Based upon this review, it is the opinion of OPRHP that no properties, including archaeological and/or historic resources, listed in or eligible for the New York State and National Registers of Historic Places will be impacted by this project.

If further correspondence is required regarding this project, please be sure to refer to the OPRHP Project Review (PR) number noted above.

Sincerely,

R. Daniel Mackay

Deputy Commissioner for Historic Preservation  
Division for Historic Preservation

---

**Division for Historic Preservation**

P.O. Box 189, Waterford, New York 12188-0189 • (518) 237-8643 • parks.ny.gov



**THE STATE EDUCATION DEPARTMENT / THE UNIVERSITY OF THE STATE OF NEW YORK**

Office of Facilities Planning, 89 Washington Avenue, Room 1060 Education Building Annex, Albany, NY 12234  
Tel. (518) 474-3906  
Email: emscfp@nysed.gov  
www.p12.nysed.gov/facplan/

**NYS Office of Parks, Recreation, and Historic Preservation  
Project Review Exemption Based on the  
Letter of Resolution**

District:	St. Lawrence-Lewis BOCES	Date:	09/26/19
Building:	Seaway Tech. Learning Resource Center	Firm:	MARCH Associates
Building Address:	7225 State Highway 56, Norwood, NY 13668	Firm Address:	258 Genesee Street, Suite 300 Utica, NY 13502

SED Project Control Number 5 1 9 0 0 0 0 0 7 0 0 8 0 0 3

In Accordance with the Letter of Resolution (LOR) between the New York State Education Department (SED), and the New York State Office of Parks, Recreation, and Historic Preservation (OPRHP), this project is **exempt** from OPRHP review based on the following:

The Building is less than 50 years old at the time of project initiation and it is not the work of a recognized Master Architect, Designer, or Builder, or associated with persons or events significant in the history of the State of New York.

The undersigned licensed professional hereby certifies that regardless of the above selection, any portions of the project that include site work or ground disturbance, not in compliance with Appendix A, have been submitted to OPRHP for review of possible impacts to archeological resources. If submitted for OPRHP review, attach a copy of the transmittal letter or the SHPO determination letter.

This Building is 50 years old or older. The entire building has been previously evaluated by OPRHP and found not to meet the criteria for inclusion in the State and National Register. (**NOTE: Attach previous determination from OPRHP stating the entire building does not meet criteria.**)

The undersigned licensed professional hereby certifies that regardless of the above selection, any portions of the project that include site work or ground disturbance, not in compliance with Appendix A, have been submitted to OPRHP for review of possible impacts to archeological resources. If submitted for OPRHP review, attach a copy of the transmittal letter or the SHPO determination letter.

The project work on this building falls under Appendix A of the LOR, has been designed in accordance with the LOR, certain scope of work items have been submitted to OPRHP for review and approval if required by the LOR, and therefore the project will have little or no potential impact on the character of historic resources. (**NOTE: Attach copy of transmittal submitting portions of work to OPRHP if required.**)

The undersigned licensed professional hereby certifies that regardless of the above selection, any portions of the project that include site work or ground disturbance, not in compliance with Appendix A, have been submitted to OPRHP for review of possible impacts to archeological resources. If submitted for OPRHP review, attach a copy of the transmittal letter or the SHPO determination letter.

**CERTIFICATION:**

The undersigned licensed professional hereby certifies that the work of this project is exempt from OPRHP review for historic resources based on the above selections.

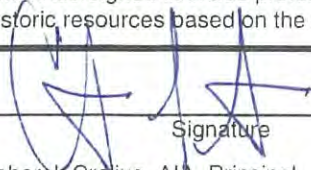
  
\_\_\_\_\_  
Signature  
Christopher J. Crolius, AIA, Principal  
\_\_\_\_\_  
Print Name

022954  
\_\_\_\_\_  
License Number